

HANSFIELD

NOTE:
NO UTILITIES DIVERSION

LEGEND FOR UTILITY SERVICES SURVEY AND PROPOSED DIVERSIONS:

—ESB—ESB—ESB—	Existing ESB - Underground	—PROP. ESB MV/LV—	Proposed ESB - MV/LV Underground Diversion	—PROP. VIRGIN—	Proposed VIRGIN Diversion
—OH—	Existing ESB - Overhead	—PROP. ESB HV—	Proposed ESB - HV Overhead Diversion	—PROP. VODAFONE—	Proposed VODAFONE Diversion
—EIRCOM—	Existing EIRCOM	—PROP. ESB MV—	Proposed ESB - MV Overhead Diversion	—PROP. AUR—	Proposed AURORA Diversion
—STORM WATER—	Existing Storm Water	—PROP. ESB LV—	Proposed ESB - LV Overhead Diversion	—PROP. EU—	Proposed EU Network Diversion
—GAS—	Existing Gas Network	—PROP. ESB HV—	Proposed ESB - HV Underground Diversion	—PROP. GAS LP—	Proposed GAS LP Diversion
—GRAVITY FOUL—	Existing IW-Gravity	—PROP. IW-GM—	Proposed IW- WATER Main Diversion	—PROP. GAS MP—	Proposed GAS MP Diversion
—VIRGIN—	Existing Virgin	—PROP. IW-GF—	Proposed IW-GRAVITY FOUL Diversion	—PROP. GAS HP—	Proposed GAS HP Diversion
—VODAFONE—	Existing Vodafone	—PROP. SW—	Proposed STORM WATER Diversion	—	—
—EU NETWORK—	Existing EU Network	—PROP. EIRCOM—	Proposed EIRCOM Diversion	—	—
—AURORA—	Existing Aurora	—	—	—	—
—WM—	Existing Water Main	—	—	—	—



V 01	May 2022	Planning Issue	JHC	LA	CCH
REV.	DATE	DESCRIPTION	PRODUCED BY	REVIEWED BY	APPROVED BY

© Irish Rail (2021). This drawing is confidential and the copyright in it is owned by Irish Rail. This drawing must not be either loaned, copied or otherwise reproduced in whole or in part or used for any purpose without the prior permission of Irish Rail.
 © Ordnance Survey, Ireland and Government of Ireland. All O.S. data used for plans are printed under "Copyright Ordnance Survey Ireland".
 Survey No. 0039720 (OSi Aerial Data or OSi Lidar Data) & Survey No. 2021/051, NMA, 180 (OSi Vector Data).
 All elevations are in metres and relate to OSi Geoid Model (OSGM02) Mean Head as defined by existing Project Control.
 All Co-ordinates are in Irish Transverse Mercator Grid (ITM) as defined by OSi active GPS station Tallaght College (TLG0).

Client

Consultant

Project

Drawing Title

**UTILITIES DIVERSION
HANSFIELD SUBSTATION**

Scale: 1:250 @ A1

Drawing Number	Project	Originator	Discipline	Location	Type	Role	Number	Phase
P/101086	MAY MDC	UTL	RS15	DR	Y	0001	D	

Date:	Job No:	Status:	Rev:	Sheet:
May 2022	P/101086	F1-Approved&Accepted	V 01	01 of 01

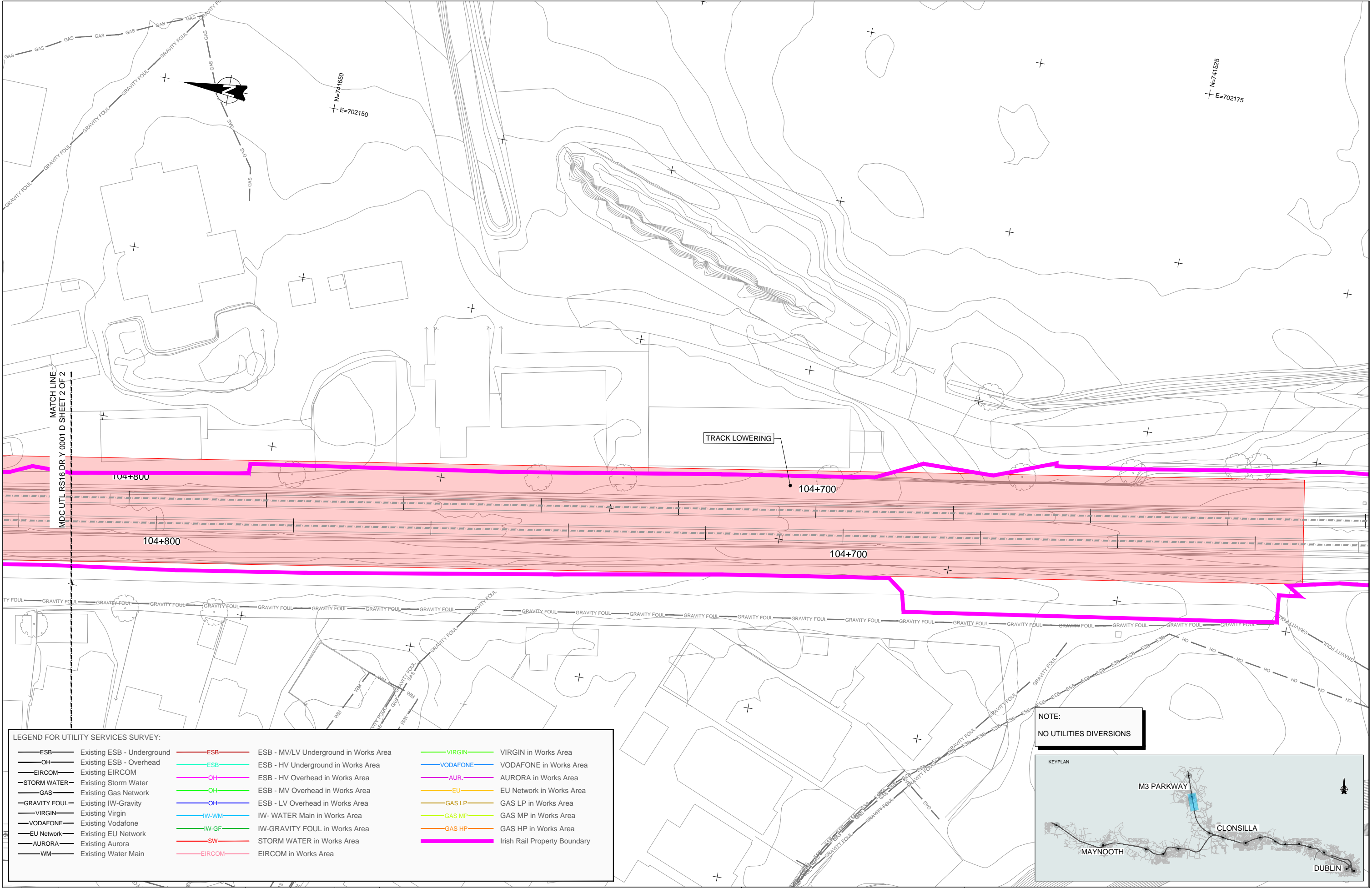

MATCH LINE
MDC UTL RS16 DR Y 0001 D SHEET 2 OF 2

TRACK LOWERING

NOTE:
NO UTILITIES DIVERSIONS



LEGEND FOR UTILITY SERVICES SURVEY:

— ESB — Existing ESB - Underground	— ESB — ESB - MV/LV Underground in Works Area	— VIRGIN — VIRGIN in Works Area
— OH — Existing ESB - Overhead	— ESB — ESB - HV Underground in Works Area	— VODAFONE — VODAFONE in Works Area
— EIRCOM — Existing EIRCOM	— OH — ESB - HV Overhead in Works Area	— AUR — AURORA in Works Area
— STORM WATER — Existing Storm Water	— OH — ESB - MV Overhead in Works Area	— EU — EU Network in Works Area
— GAS — Existing Gas Network	— OH — ESB - LV Overhead in Works Area	— GAS LP — GAS LP in Works Area
— GRAVITY FOUL — Existing IW-Gravity	— IW-WM — IW- WATER Main in Works Area	— GAS MP — GAS MP in Works Area
— VIRGIN — Existing Virgin	— IW-GF — IW-GRAVITY FOUL in Works Area	— GAS HP — GAS HP in Works Area
— VODAFONE — Existing Vodafone	— SW — STORM WATER in Works Area	— EIRCOM — EIRCOM in Works Area
— EU Network — Existing EU Network		
— AURORA — Existing Aurora		
— WM — Existing Water Main		

V 01	May 2022	Planning Issue	JHC	LA	CCH
REV.	DATE	DESCRIPTION	PRODUCED BY	REVIEWED BY	APPROVED BY

© Irish Rail (2021). This drawing is confidential and the copyright in it is owned by Irish Rail. This drawing must not be either loaned, copied or otherwise reproduced in whole or in part or used for any purpose without the prior permission of Irish Rail.
 © Ordnance Survey, Ireland and Government of Ireland. All O.S. data used for plans are printed under "Copyright Ordnance Survey Ireland".
 Survey No. 0039720 (OSI Aerial Data or OS Lidar Data) & Survey No. 2021081, NMA, 180 (OSI Vector Data).
 All elevations are in metres and relate to OS Geoid Model (OSGM02) Mean Head as defined by existing Project Control.
 All Co-ordinates are in Irish Transverse Mercator Grid (ITM) as defined by OSI active GPS station Tallaght College (TLLG).

Client

Thionscald Éireann Project Ireland 2040

NTA Údarás Náisiúnta Comair

Iarnród Éireann Irish Rail

Consultant

IDOM

G3

FIROD

Project

DART+ West

Drawing Title

UTILITIES DIVERSIONS
OBCN290 TRACK LOWERING

Scale: 1:250 @ A1

0 2.5 5 10 20

Drawing Number | Project | Originator | Discipline | Location | Type | Role | Number | Phase

MAY MDC UTL RS16 DR Y 0001 D

Date: May 2022 | Job No: P/101086 | Status: F1-Approved&Accepted | Rev: V 01 | Sheet: 01 of 02

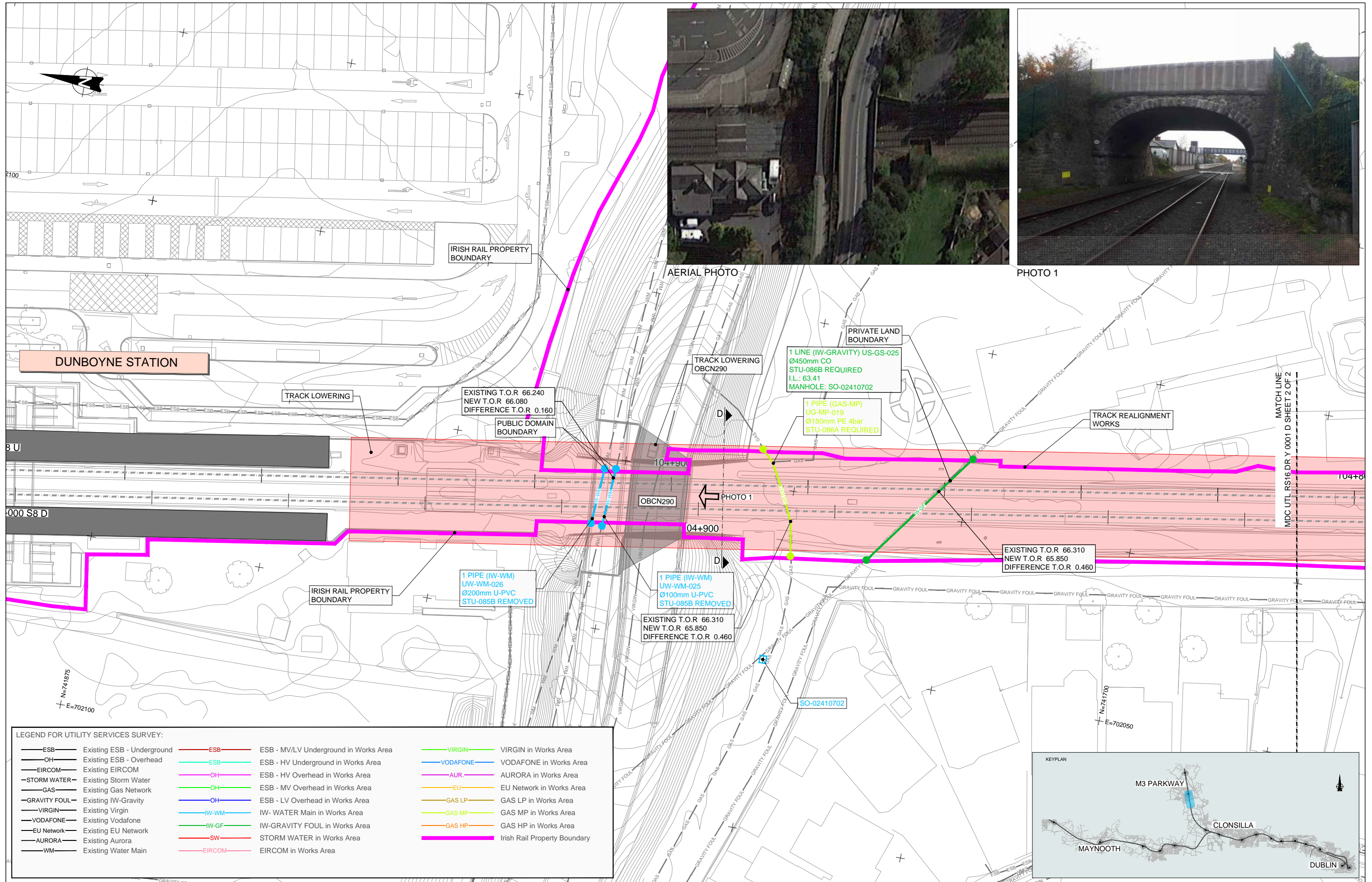

LEGEND FOR UTILITY SERVICES SURVEY:

— ESB — Existing ESB - Underground	— ESB — ESB - MV/LV Underground in Works Area	— VIRGIN — VIRGIN in Works Area
— OH — Existing ESB - Overhead	— ESB — ESB - HV Underground in Works Area	— VODAFONE — VODAFONE in Works Area
— EIRCOM — Existing EIRCOM	— OH — ESB - HV Overhead in Works Area	— AUR — AURORA in Works Area
— STORM WATER — Existing Storm Water	— OH — ESB - MV Overhead in Works Area	— EU — EU Network in Works Area
— GAS — Existing Gas Network	— OH — ESB - LV Overhead in Works Area	— GAS LP — GAS LP in Works Area
— GRAVITY FOUL — Existing IW-Gravity	— IW-WM — IW- WATER Main in Works Area	— GAS MP — GAS MP in Works Area
— VIRGIN — Existing Virgin	— IW-GF — IW-GRAVITY FOUL in Works Area	— GAS HP — GAS HP in Works Area
— VODAFONE — Existing Vodafone	— SW — STORM WATER in Works Area	— IRISH RAIL PROPERTY BOUNDARY
— EU Network — Existing EU Network	— EIRCOM — EIRCOM in Works Area	
— AURORA — Existing Aurora		
— WM — Existing Water Main		

V 01 May 2022 Planning Issue REV. DATE DESCRIPTION JHC LA CCH PRODUCED BY REVIEWED BY APPROVED BY			Client 	Project 	Drawing Title UTILITIES DIVERSIONS OBCN290 TRACK LOWERING
© Irish Rail (2021). This drawing is confidential and the copyright in it is owned by Irish Rail. This drawing must not be either loaned, copied or otherwise reproduced in whole or in part or used for any purpose without the prior permission of Irish Rail. © Ordnance Survey, Ireland and Government of Ireland. All O.S. data used for plans are printed under "Copyright Ordnance Survey Ireland". Survey No. 0039720 (OSI Aerial Data or OS Lidar Data) & Survey No. 2021051_NMA_180 (OSI Vector Data). All elevations are in metres and relate to OS Geoid Model (OSGM02) Mean Head as defined by existing Project Control. All Co-ordinates are in Irish Transverse Mercator Grid (ITM) as defined by OSI active GPS station Tallaght College (TLG0).			Consultant 	Scale: 1:250 @ A1 	Drawing Number Project Originator Discipline Location Type Role Number Phase MAY MDC UTL RS16 DR Y 0001 D Date: May 2022 Job No: P/101086 Status: F1-Approved&Accepted Rev: V 01 Sheet: 02 of 02

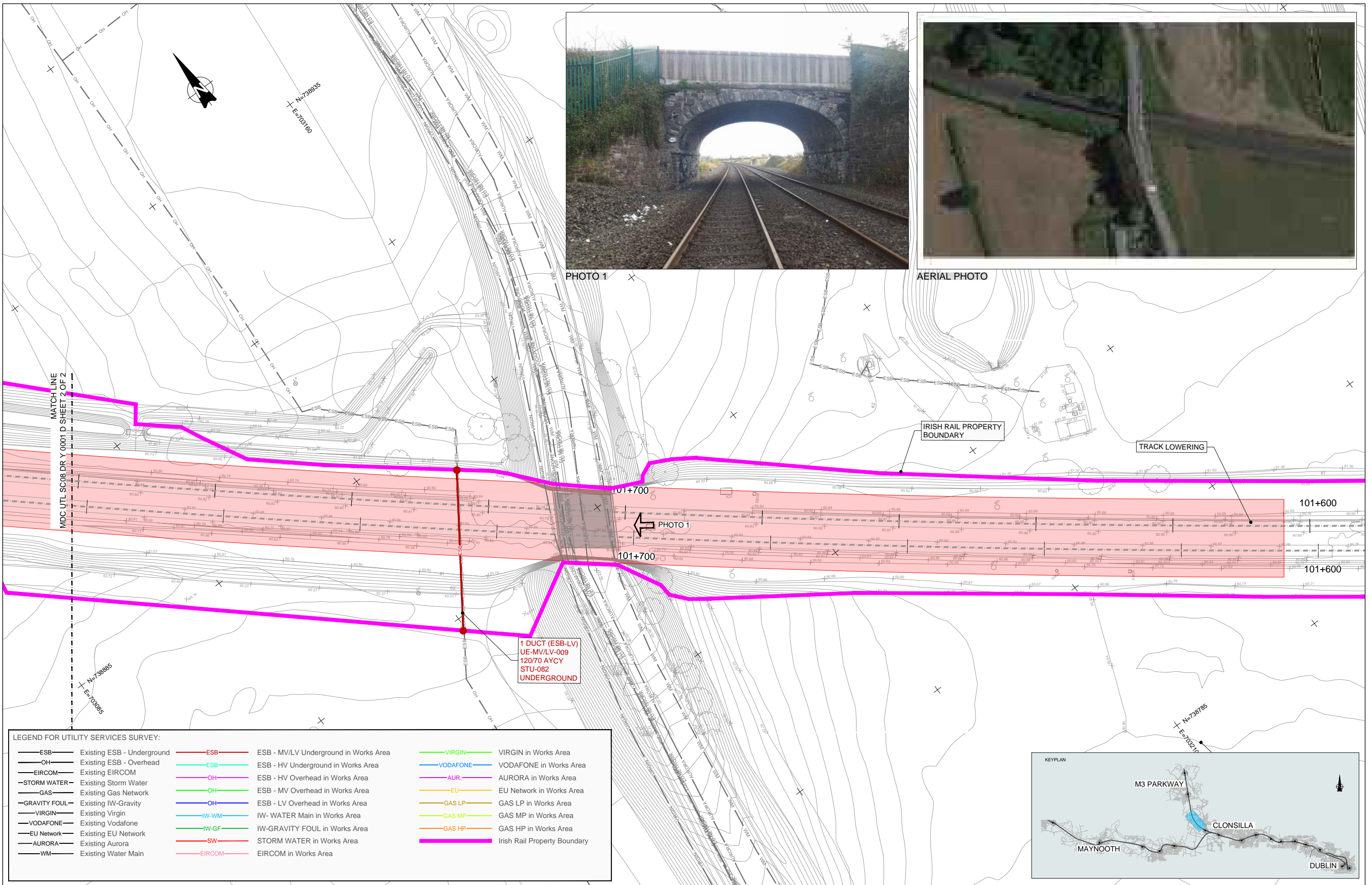

PHOTO 1



AERIAL PHOTO

1 DUCT (ESB-LV)
UE-MV/LV-009
120/70 AYC
STU-082
UNDERGROUND

LEGEND FOR UTILITY SERVICES SURVEY:

— ESB — Existing ESB - Underground	— ESB — ESB - MV/LV Underground in Works Area	— VIRGIN — VIRGIN in Works Area
— OH — Existing ESB - Overhead	— ESB — ESB - HV Underground in Works Area	— VODAFONE — VODAFONE in Works Area
— EIRCOM — Existing EIRCOM	— OH — ESB - HV Overhead in Works Area	— AUR — AURORA in Works Area
— STORM WATER — Existing Storm Water	— OH — ESB - MV Overhead in Works Area	— EU — EU Network in Works Area
— GAS — Existing Gas Network	— OH — ESB - LV Overhead in Works Area	— GAS LP — GAS LP in Works Area
— GRAVITY FOUL — Existing IW-Gravity	— IW-WM — IW- WATER Main in Works Area	— GAS MP — GAS MP in Works Area
— VIRGIN — Existing Virgin	— IW-GF — IW-GRAVITY FOUL in Works Area	— GAS HP — GAS HP in Works Area
— VODAFONE — Existing Vodafone	— SW — STORM WATER in Works Area	— IRISH RAIL — Irish Rail Property Boundary
— EU Network — Existing EU Network	— EIRCOM — EIRCOM in Works Area	
— AURORA — Existing Aurora		
— WM — Existing Water Main		



V 01	May 2022	Planning Issue	JHC	LA	CCH
REV.	DATE	DESCRIPTION	PRODUCED BY	REVIEWED BY	APPROVED BY

© Irish Rail (2021). This drawing is confidential and the copyright in it is owned by Irish Rail. This drawing must not be either loaned, copied or otherwise reproduced in whole or in part or used for any purpose without the prior permission of Irish Rail.
 © Ordnance Survey, Ireland and Government of Ireland. All O.S. data used for plans are printed under "Copyright Ordnance Survey Ireland".
 Survey No. 0039720 (OSI Aerial Data or OS Lidar Data) & Survey No. 2021/051, NMA, 180 (OSI Vector Data).
 All elevations are in metres and relate to OS Geoid Model (OSGM02) Mean Head as defined by existing Project Control.
 All Co-ordinates are in Irish Transverse Mercator Grid (ITM) as defined by OSI active GPS station Tallaght College (TLLG).

Client: **Tionscatal Éireann Project Ireland 2040**, **NTA**, **Iarnród Éireann Irish Rail**

Consultant: **IDOM**, **G3**, **FIROD**

Project: **DART+ West**

Drawing Title: **UTILITIES DIVERSIONS OBCN-286 TRACK LOWERING**

Scale: 1:250 @ A1

Drawing Number: **MAY MDC UTL SC08 DR Y 0001 D**

Date: May 2022 | Job No: P/101086 | Status: F1-Approved&Accepted | Rev: V 01 | Sheet: 01 of 02

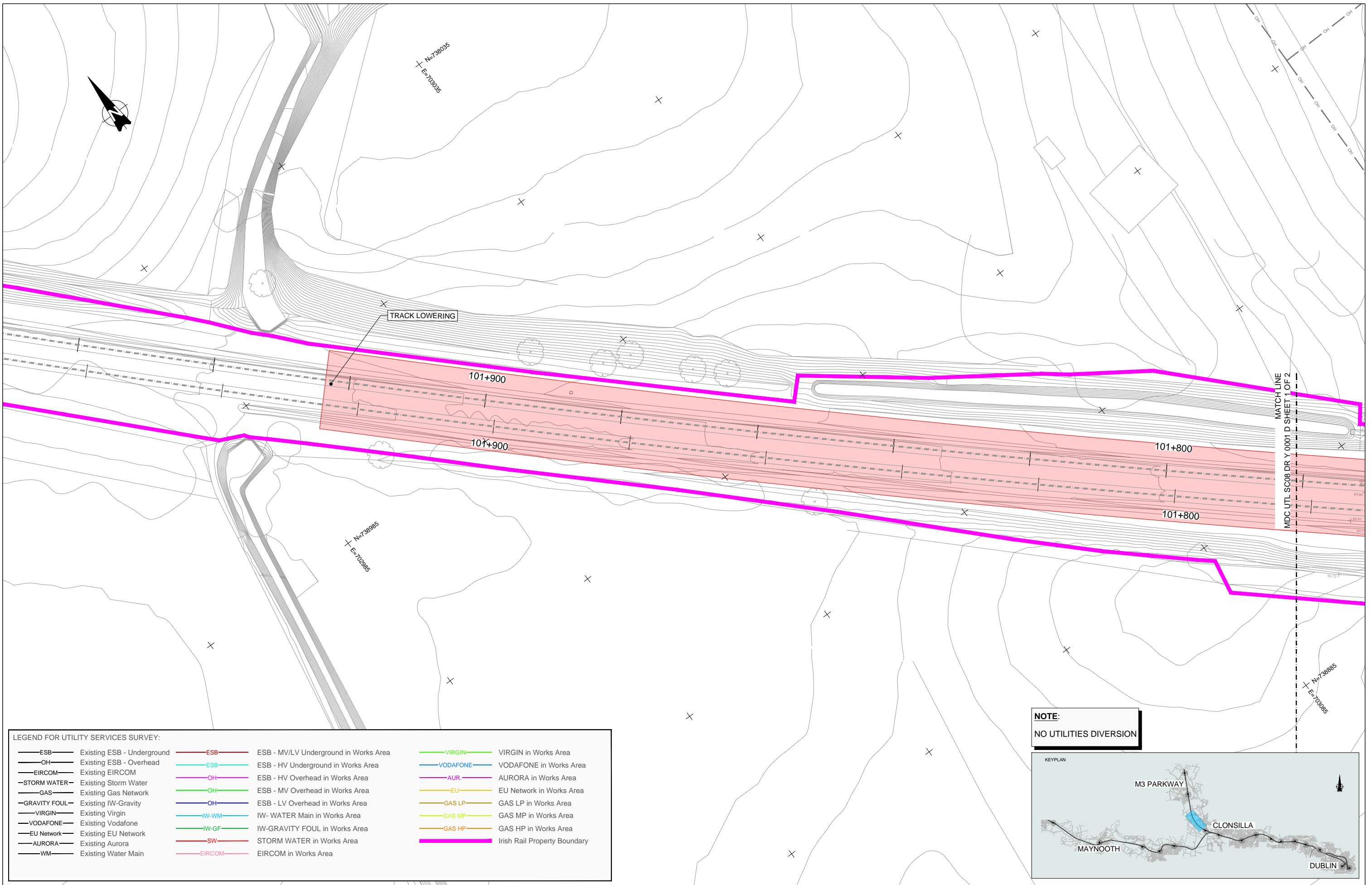

LEGEND FOR UTILITY SERVICES SURVEY:

— ESB —	Existing ESB - Underground	— ESB —	ESB - MV/LV Underground in Works Area	— VIRGIN —	VIRGIN in Works Area
— OH —	Existing ESB - Overhead	— ESB —	ESB - HV Underground in Works Area	— VODAFONE —	VODAFONE in Works Area
— EIRCOM —	Existing EIRCOM	— OH —	ESB - HV Overhead in Works Area	— AUR —	AURORA in Works Area
— STORM WATER —	Existing Storm Water	— OH —	ESB - MV Overhead in Works Area	— EU —	EU Network in Works Area
— GAS —	Existing Gas Network	— OH —	ESB - LV Overhead in Works Area	— GAS LP —	GAS LP in Works Area
— GRAVITY FOUL —	Existing IW-Gravity	— IW-WM —	IW- WATER Main in Works Area	— GAS MP —	GAS MP in Works Area
— VIRGIN —	Existing Virgin	— IW-GF —	IW-GRAVITY FOUL in Works Area	— GAS HP —	GAS HP in Works Area
— VODAFONE —	Existing Vodafone	— SW —	STORM WATER in Works Area	— EIRCOM —	EIRCOM in Works Area
— EU Network —	Existing EU Network				
— AURORA —	Existing Aurora				
— WM —	Existing Water Main				

NOTE:
NO UTILITIES DIVERSION



V 01	May 2022	Planning Issue	JHC	LA	CCH
REV.	DATE	DESCRIPTION	PRODUCED BY	REVIEWED BY	APPROVED BY

© Irish Rail (2021). This drawing is confidential and the copyright in it is owned by Irish Rail. This drawing must not be either loaned, copied or otherwise reproduced in whole or in part or used for any purpose without the prior permission of Irish Rail.
 © Ordnance Survey, Ireland and Government of Ireland. All O.S. data used for plans are printed under "Copyright Ordnance Survey Ireland".
 Survey No. 0039720 (OSI Aerial Data or OSI Lidar Data) & Survey No. 2021/OSI_NMA_180 (OSI Vector Data).
 All elevations are in metres and relate to OS Geoid Model (OSGM02) Malin Head as defined by existing Project Control.
 All Co-ordinates are in Irish Transverse Mercator Grid (ITM) as defined by OSI active GPS station Tallaght College (TLLG).

Client

Consultant

Project

Drawing Title

**UTILITIES DIVERSIONS
OBCN-286
TRACK LOWERING**

Scale: 1:250 @ A1

Drawing Number	Project	Originator	Discipline	Location	Type	Role	Number	Phase
MAY MDC UTL SC08 DR Y 0001 D								

Date:	Job No:	Status:	Rev:
May 2022	P/101086	F1-Approved&Accepted	V 01

Sheet: 02 of 02

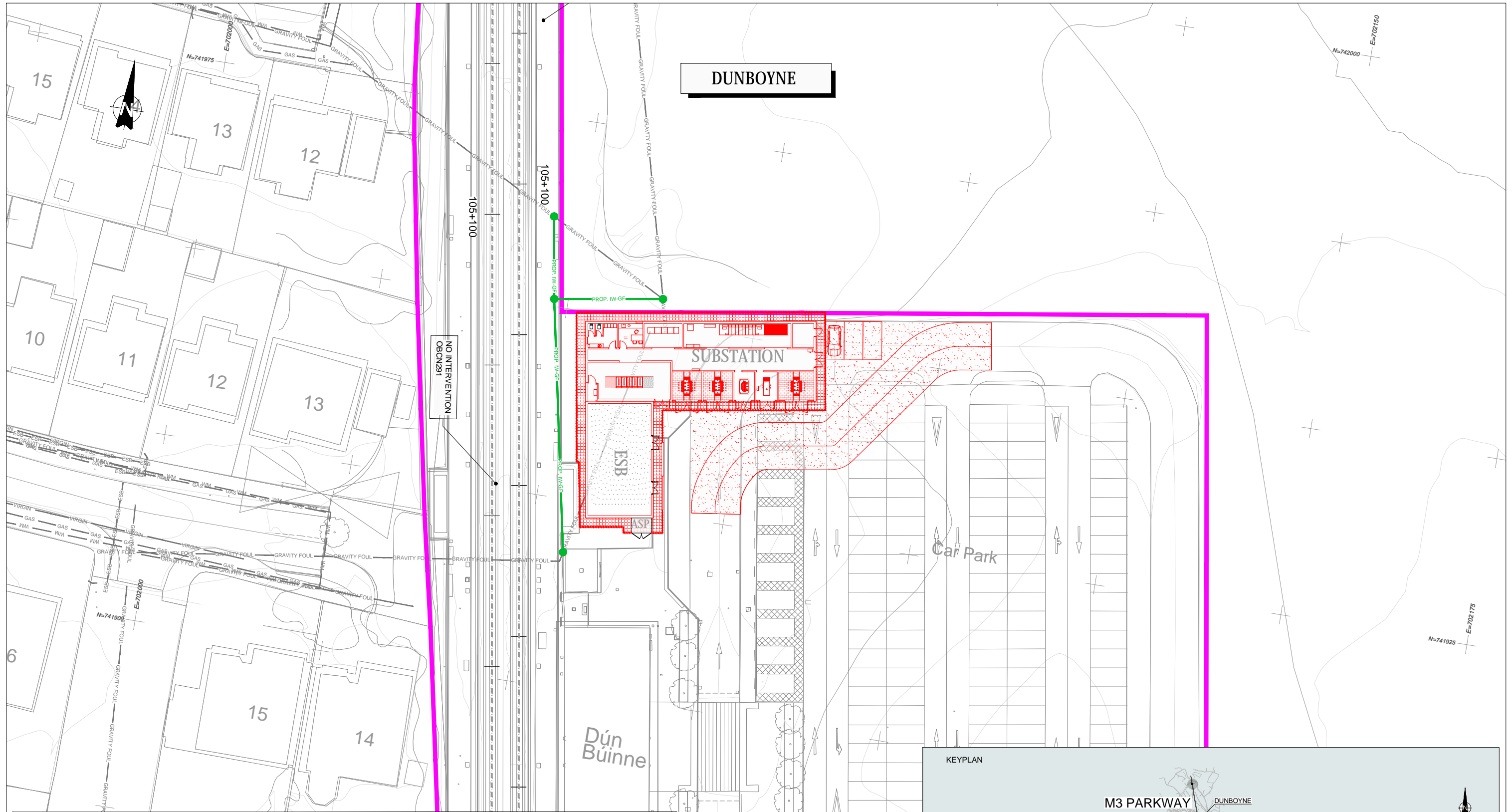

DUNBOYNE

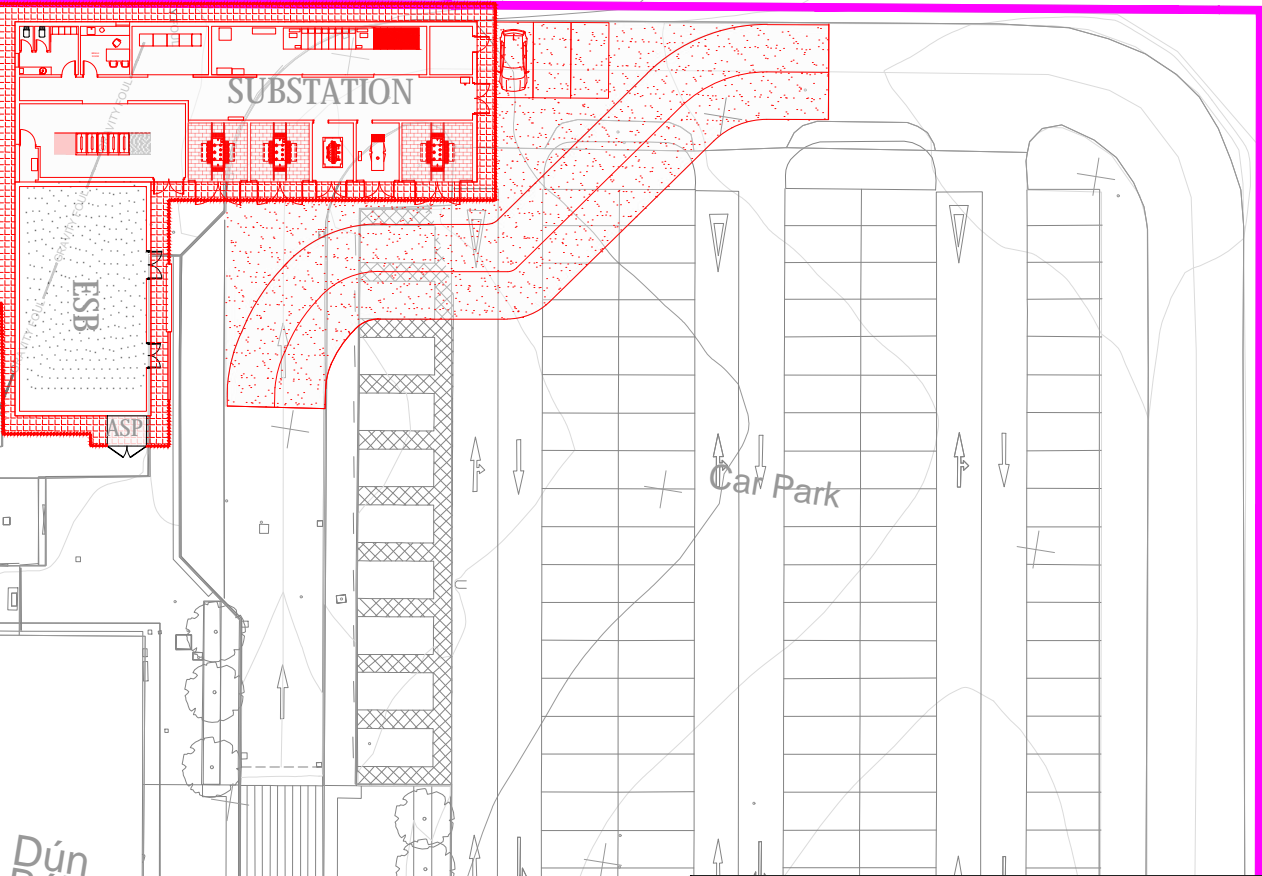

NO INTERVENTION
OBCN291

LEGEND FOR UTILITY SERVICES SURVEY AND PROPOSED DIVERSIONS:

—ESB—ESB—ESB—	Existing ESB - Underground	—PROP. ESB MV/LV—	Proposed ESB - MV/LV Underground Diversion	—PROP. VIRGIN—	Proposed VIRGIN Diversion
—OH—	Existing ESB - Overhead	—PROP. ESB HV—	Proposed ESB - HV Overhead Diversion	—PROP. VODAFONE—	Proposed VODAFONE Diversion
—EIRCOM—	Existing EIRCOM	—PROP. ESB MV—	Proposed ESB - MV Overhead Diversion	—PROP. AUR—	Proposed AURORA Diversion
—STORM WATER—	Existing Storm Water	—PROP. ESB LV—	Proposed ESB - LV Overhead Diversion	—PROP. EU—	Proposed EU Network Diversion
—GAS—	Existing Gas Network	—PROP. ESB HV—	Proposed ESB - HV Underground Diversion	—PROP. GAS LP—	Proposed GAS LP Diversion
—GRAVITY FOUL—	Existing IW-Gravity	—PROP. IW-GM—	Proposed IW- WATER Main Diversion	—PROP. GAS MP—	Proposed GAS MP Diversion
—VIRGIN—	Existing Virgin	—PROP. IW-GF—	Proposed IW-GRAVITY FOUL Diversion	—PROP. GAS HP—	Proposed GAS HP Diversion
—VODAFONE—	Existing Vodafone	—PROP. SW—	Proposed STORM WATER Diversion	—	—
—EU NETWORK—	Existing EU Network	—PROP. EIRCOM—	Proposed EIRCOM Diversion	—	—
—AURORA—	Existing Aurora			—	—
—WM—	Existing Water Main			—	—



V 01	May 2022	Planning Issue	JHC	LA	CCH
REV.	DATE	DESCRIPTION	PRODUCED BY	REVIEWED BY	APPROVED BY

© Irish Rail (2021). This drawing is confidential and the copyright in it is owned by Irish Rail. This drawing must not be either loaned, copied or otherwise reproduced in whole or in part or used for any purpose without the prior permission of Irish Rail.
 © Ordnance Survey, Ireland and Government of Ireland. All O.S. data used for plans are printed under "Copyright Ordnance Survey Ireland".
 Survey No. 0039720 (OSI Aerial Data or OS Lidar Data) & Survey No. 2021/051, NMA, 190 (OSI Vector Data).
 All elevations are in metres and relate to OSi Geoid Model (OSGM02) Mean Head as defined by existing Project Control.
 All Co-ordinates are in Irish Transverse Mercator Grid (ITM) as defined by OSi active GPS station Tallaght College (TLTG).

Client: **Tionscadal Éireann Project Ireland 2040**, **NTA** (Udarás Náisiúnta Iompará Náisiúnta Transport Authority), **Iarnród Éireann Irish Rail**

Consultant: **IDOM**, **G3**, **FIROD** (RUBINIAN & O'DONOVAN)

Project: **DART+ West**

Drawing Title: **UTILITIES DIVERSION DUNBOYNE SUBSTATION**

Scale: 1:250 @ A1

Drawing Number: **MAY MDC UTL RS16 DR Y 0002 D**

Date: May 2022 | Job No: P/101086 | Status: F1-Approved&Accepted | Rev: V 01 | Sheet: 01 of 01

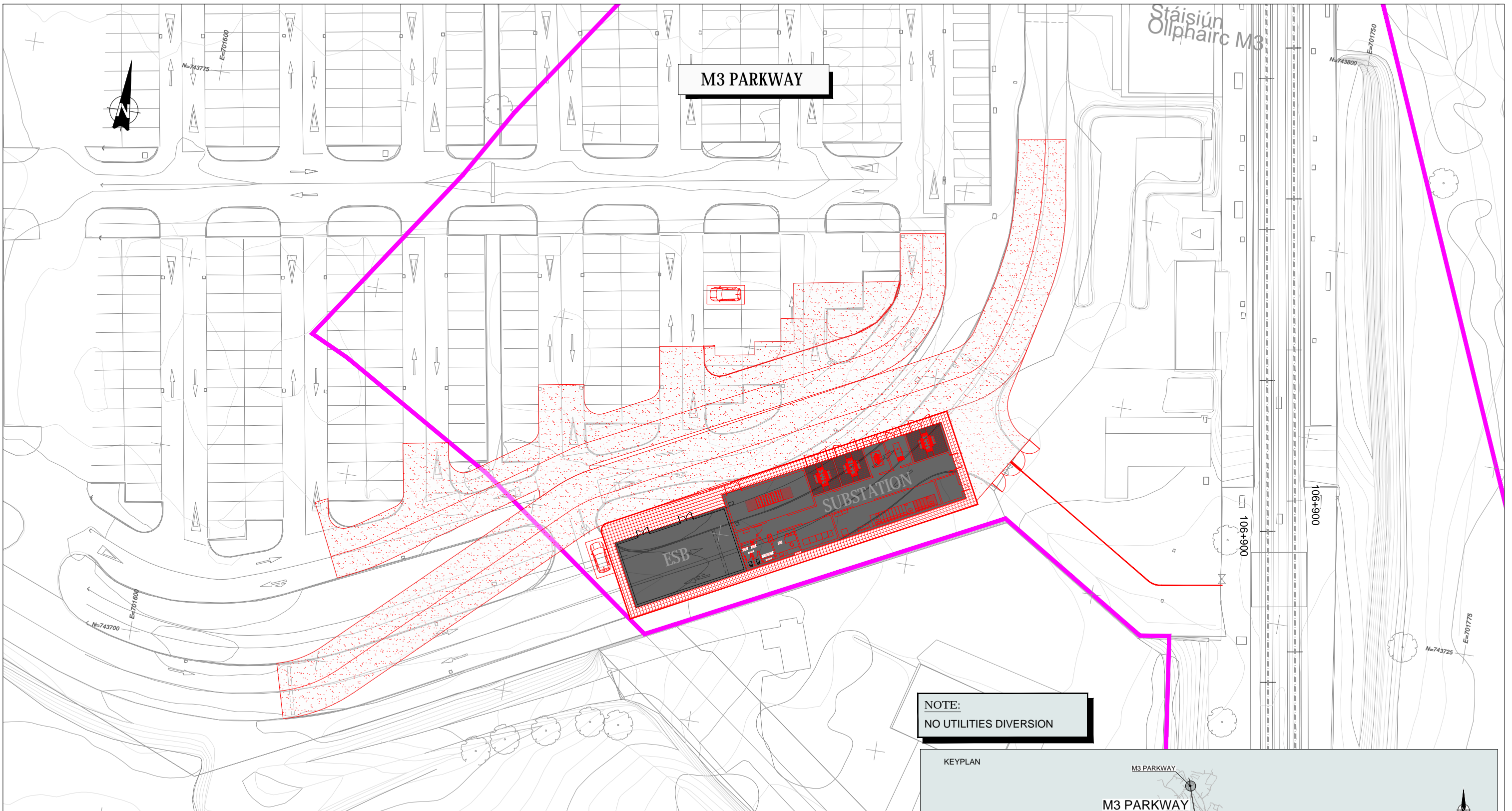

M3 PARKWAY

Stáisiún Oilphairc M3

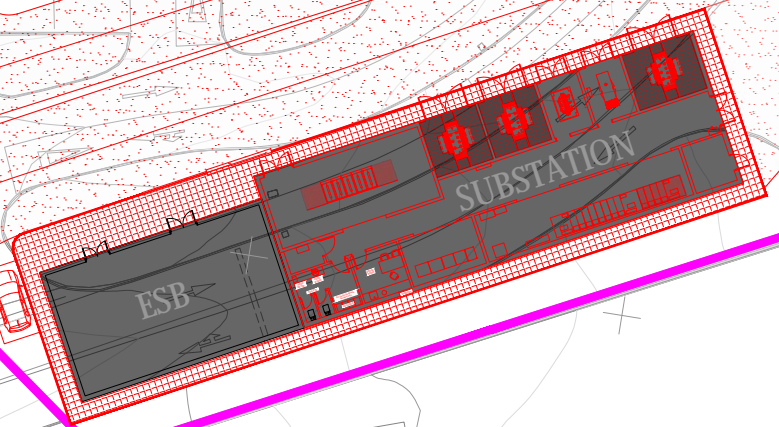

NOTE:
NO UTILITIES DIVERSION

LEGEND FOR UTILITY SERVICES SURVEY AND PROPOSED DIVERSIONS:

—ESB—ESB—ESB— Existing ESB - Underground	—PROP. ESB MV/LV— Proposed ESB - MV/LV Underground Diversion	—PROP. VIRGIN— Proposed VIRGIN Diversion
—OH— Existing ESB - Overhead	—PROP. ESB HV— Proposed ESB - HV Overhead Diversion	—PROP. VODAFONE— Proposed VODAFONE Diversion
—EIRCOM— Existing EIRCOM	—PROP. ESB MV— Proposed ESB - MV Overhead Diversion	—PROP. AUR— Proposed AURORA Diversion
—STORM WATER— Existing Storm Water	—PROP. ESB LV— Proposed ESB - LV Overhead Diversion	—PROP. EU— Proposed EU Network Diversion
—GAS— Existing Gas Network	—PROP. ESB HV— Proposed ESB - HV Underground Diversion	—PROP. GAS LP— Proposed GAS LP Diversion
—GRAVITY FOUL— Existing IW-Gravity	—PROP. IW-GM— Proposed IW- WATER Main Diversion	—PROP. GAS MP— Proposed GAS MP Diversion
—VIRGIN— Existing Virgin	—PROP. IW-GF— Proposed IW-GRAVITY FOUL Diversion	—PROP. GAS HP— Proposed GAS HP Diversion
—VODAFONE— Existing Vodafone	—PROP. SW— Proposed STORM WATER Diversion	—Irish Rail Property Boundary— Irish Rail Property Boundary
—EU NETWORK— Existing EU Network	—PROP. EIRCOM— Proposed EIRCOM Diversion	
—AURORA— Existing Aurora		
—WM— Existing Water Main		

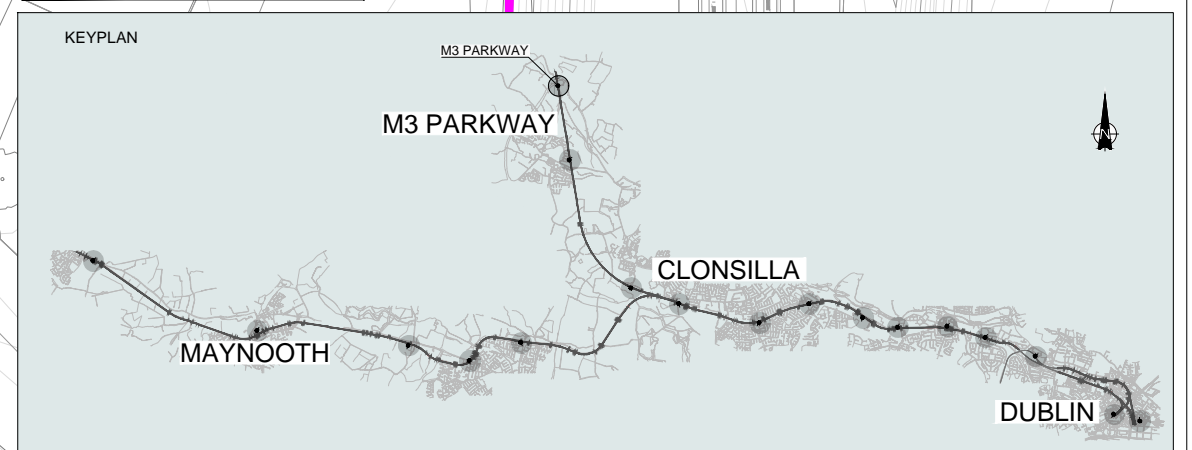

V 01	May 2022	Planning Issue	JHC	LA	CCH
REV.	DATE	DESCRIPTION	PRODUCED BY	REVIEWED BY	APPROVED BY

© Irish Rail (2021). This drawing is confidential and the copyright in it is owned by Irish Rail. This drawing must not be either loaned, copied or otherwise reproduced in whole or in part or used for any purpose without the prior permission of Irish Rail.
 © Ordnance Survey, Ireland and Government of Ireland. All O.S. data used for plans are printed under "Copyright Ordnance Survey Ireland".
 Survey No. 0039720 (OSI Aerial Data or OS Lidar Data) & Survey No. 2021051, NMA, 180 (OSI Vector Data).
 All elevations are in metres and relate to OS Geoid Model (OSGM02) Mean Head as defined by existing Project Control.
 All Co-ordinates are in Irish Transverse Mercator Grid (ITM) as defined by OS active GPS station Tallaght College (TLTG).

Client

Consultant

Project

Drawing Title

**UTILITIES DIVERSION
M3 PARKWAY SUBSTATION**

Scale: 1:250 @ A1

Drawing Number | Project | Originator | Discipline | Location | Type | Role | Number | Phase

MAY MDC UTL RS17 DR Y 0001 D

Date: May 2022 | Job No: P/101086 | Status: F1-Approved&Accepted | Rev: V 01 | Sheet: 01 of 01

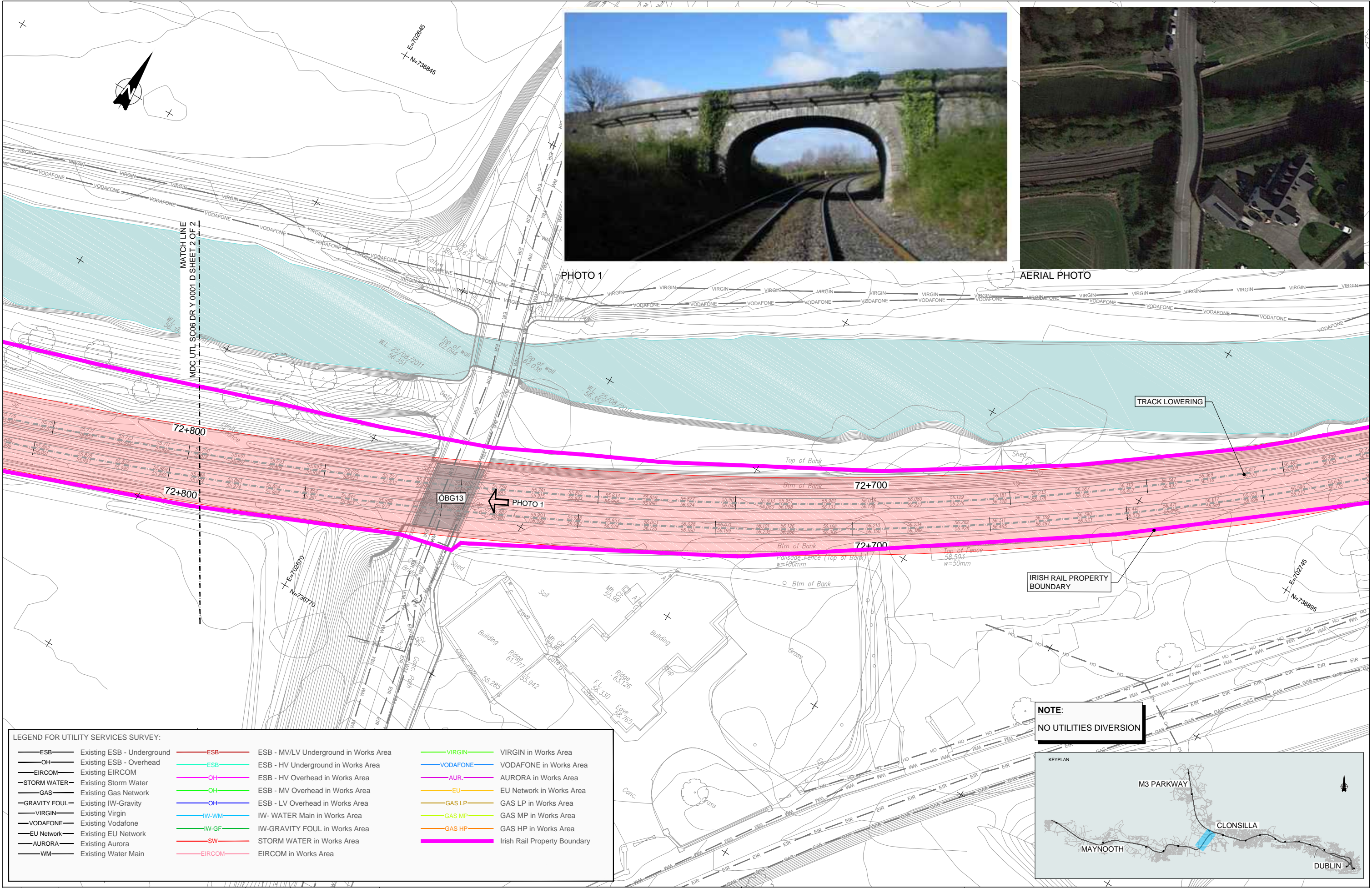

LEGEND FOR UTILITY SERVICES SURVEY:

— ESB —	Existing ESB - Underground	— ESB —	ESB - MV/LV Underground in Works Area	— VIRGIN —	VIRGIN in Works Area
— OH —	Existing ESB - Overhead	— ESB —	ESB - HV Underground in Works Area	— VODAFONE —	VODAFONE in Works Area
— EIRCOM —	Existing EIRCOM	— OH —	ESB - HV Overhead in Works Area	— AUR. —	AURORA in Works Area
— STORM WATER —	Existing Storm Water	— OH —	ESB - MV Overhead in Works Area	— EU —	EU Network in Works Area
— GAS —	Existing Gas Network	— OH —	ESB - LV Overhead in Works Area	— GAS LP —	GAS LP in Works Area
— GRAVITY FOUL —	Existing IW-Gravity	— IW-WM —	IW- WATER Main in Works Area	— GAS MP —	GAS MP in Works Area
— VIRGIN —	Existing Virgin	— IW-GF —	IW-GRAVITY FOUL in Works Area	— GAS HP —	GAS HP in Works Area
— VODAFONE —	Existing Vodafone	— SW —	STORM WATER in Works Area	— IRISH RAIL —	Irish Rail Property Boundary
— EU Network —	Existing EU Network	— EIRCOM —	EIRCOM in Works Area		
— AURORA —	Existing Aurora				
— WM —	Existing Water Main				

NOTE:
NO UTILITIES DIVERSION



V 01	May 2022	Planning Issue	JHC	LA	CCH
REV.	DATE	DESCRIPTION	PRODUCED BY	REVIEWED BY	APPROVED BY

© Irish Rail (2021). This drawing is confidential and the copyright in it is owned by Irish Rail. This drawing must not be either loaned, copied or otherwise reproduced in whole or in part or used for any purpose without the prior permission of Irish Rail.
 © Ordnance Survey, Ireland and Government of Ireland. All O.S. data used for plans are printed under "Copyright Ordnance Survey Ireland".
 Survey No. 0039720 (OS Aerial Data or OS Lidar Data) & Survey No. 2021/081, NMA, 180 (OS Vector Data).
 All elevations are in metres and relate to OS Geoid Model (OSGM02) Mean Head as defined by existing Project Control.
 All Co-ordinates are in Irish Transverse Mercator Grid (ITM) as defined by OSi active GPS station Tallaght College (TLG0).

Client: **Tionscadal Éireann Project Ireland 2040**, **NTA** (Udarás Náisiúnta Ionstráide), **Iarnród Éireann Irish Rail**

Consultant: **IDOM**, **G3**, **FIROD**

Project: **DART+ West**

Drawing Title: **UTILITIES DIVERSIONS OBG-13 TRACK LOWERING**

Scale: 1:250 @ A1

Drawing Number: **MAY MDC UTL SC06 DR Y 0001 D**

Date: May 2022 | Job No: P/101086 | Status: F1-Approved&Accepted | Rev: V 01 | Sheet: 01 of 02

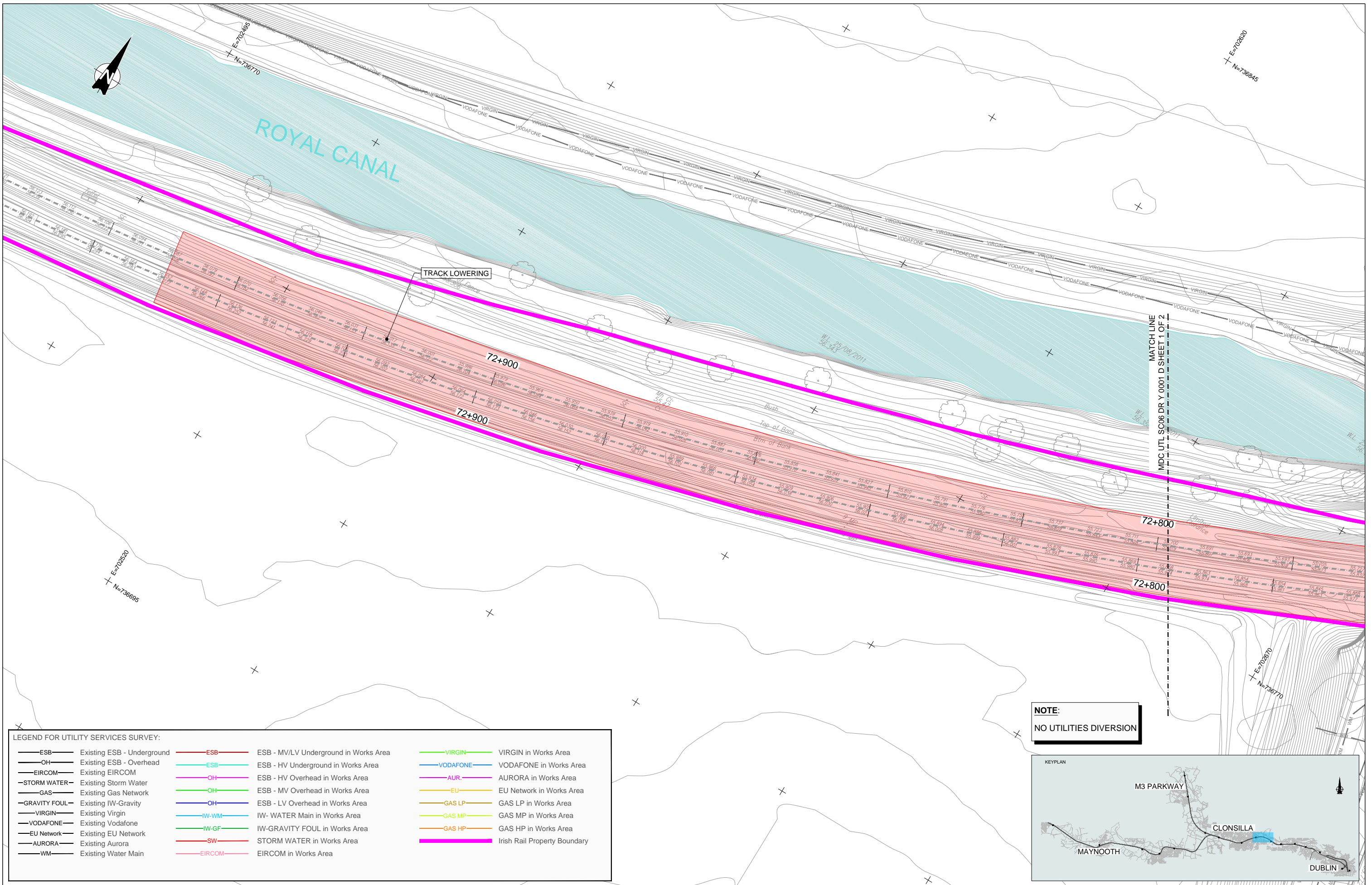

LEGEND FOR UTILITY SERVICES SURVEY:

— ESB —	Existing ESB - Underground	— ESB —	ESB - MV/LV Underground in Works Area	— VIRGIN —	VIRGIN in Works Area
— OH —	Existing ESB - Overhead	— ESB —	ESB - HV Underground in Works Area	— VODAFONE —	VODAFONE in Works Area
— EIRCOM —	Existing EIRCOM	— OH —	ESB - HV Overhead in Works Area	— AUR —	AURORA in Works Area
— STORM WATER —	Existing Storm Water	— OH —	ESB - MV Overhead in Works Area	— EU —	EU Network in Works Area
— GAS —	Existing Gas Network	— OH —	ESB - LV Overhead in Works Area	— GAS LP —	GAS LP in Works Area
— GRAVITY FOUL —	Existing IW-Gravity	— OH —	IW- WATER Main in Works Area	— GAS MP —	GAS MP in Works Area
— VIRGIN —	Existing Virgin	— IW-GF —	IW-GRAVITY FOUL in Works Area	— GAS HP —	GAS HP in Works Area
— VODAFONE —	Existing Vodafone	— SW —	STORM WATER in Works Area	— EIRCOM —	EIRCOM in Works Area
— EU Network —	Existing EU Network	— WM —	Existing Water Main		
— AURORA —	Existing Aurora				
— WM —	Existing Water Main				

NOTE:
NO UTILITIES DIVERSION

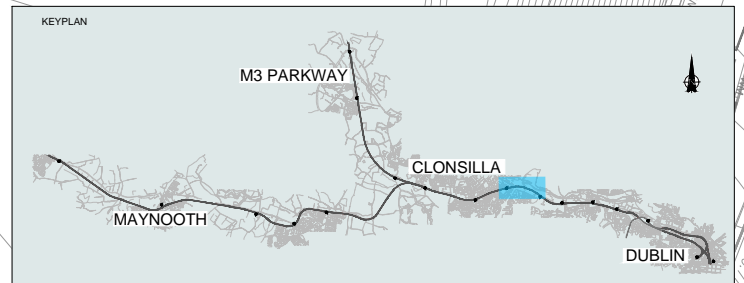

V 01 May 2022 Planning Issue REV. DATE DESCRIPTION JHC LA CCH PRODUCED BY REVIEWED BY APPROVED BY			Client 		Project 		Drawing Title UTILITIES DIVERSIONS OBG-13 TRACK LOWERING	
© Irish Rail (2021). This drawing is confidential and the copyright in it is owned by Irish Rail. This drawing must not be either loaned, copied or otherwise reproduced in whole or in part or used for any purpose without the prior permission of Irish Rail. © Ordnance Survey, Ireland and Government of Ireland. All O.S. data used for plans are printed under "Copyright Ordnance Survey Ireland". Survey No. 0039720 (OS Aerial Data or OS Lidar Data) & Survey No. 2021/081, NMA, 180 (OS Vector Data). All elevations are in metres and relate to OS Geoid Model (OSGM02) Mean Head as defined by existing Project Control. All Co-ordinates are in Irish Transverse Mercator Grid (ITM) as defined by OSi active GPS station Tallaght College (TLG0).			Consultant 		Scale: 1:250 @ A1 		Drawing Number Project Originator Discipline Location Type Role Number Phase MAY MDC UTL SC06 DR Y 0001 D Date: May 2022 Job No: P/101086 Status: F1-Approved&Accepted Rev: V 01 Sheet: 02 of 02	

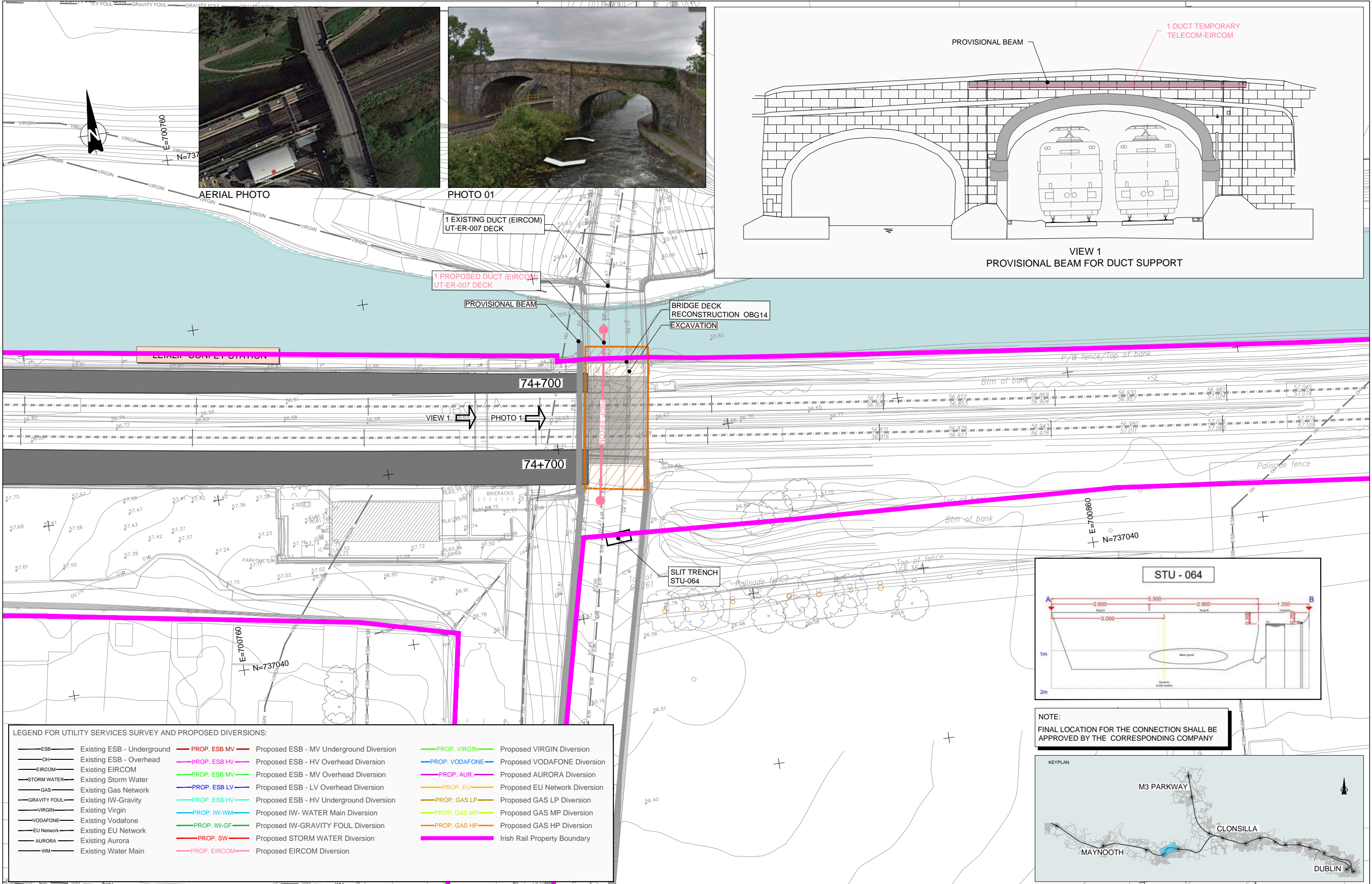

AERIAL PHOTO

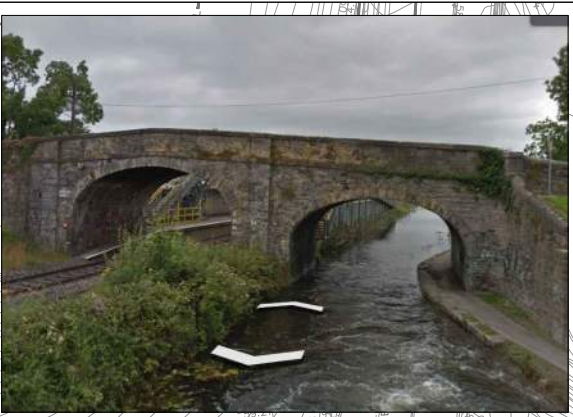
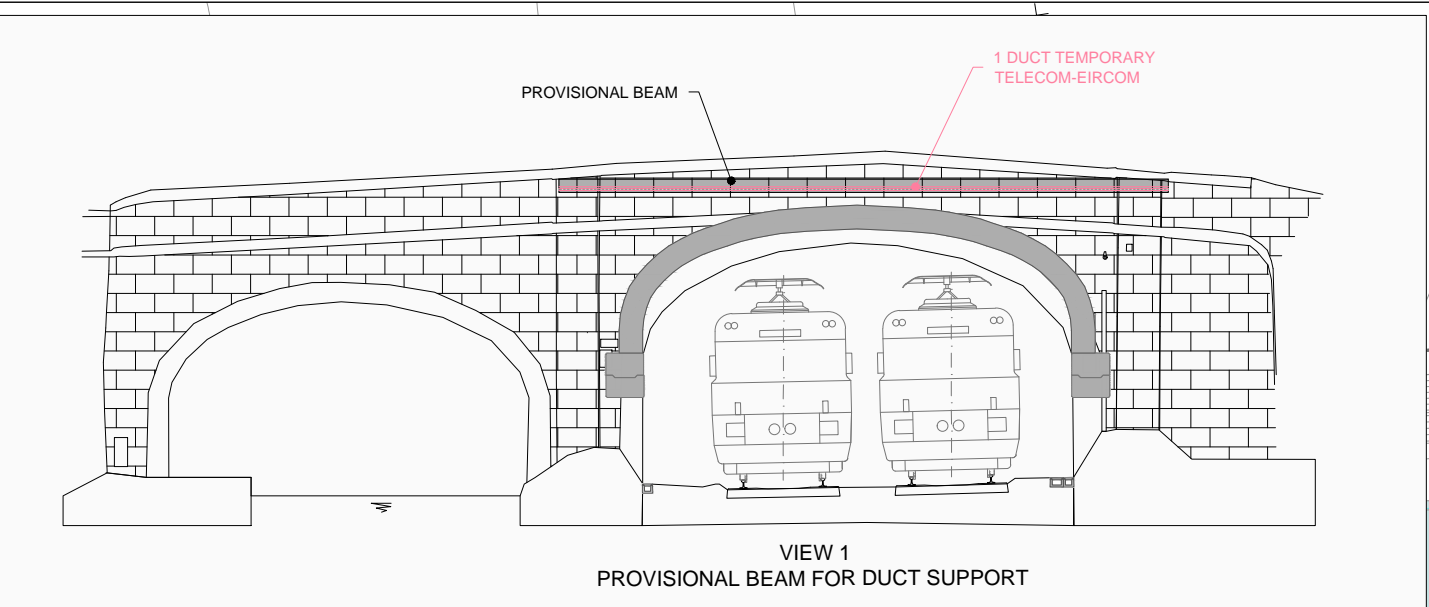
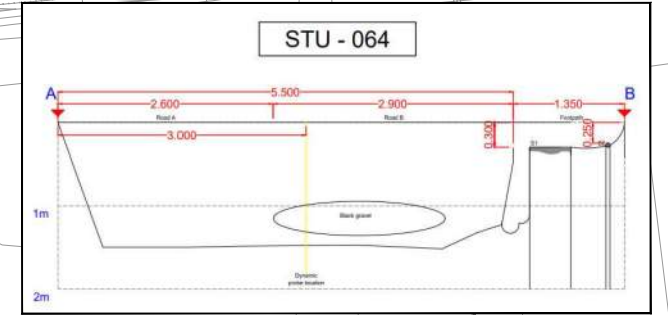

PHOTO 01



VIEW 1
PROVISIONAL BEAM FOR DUCT SUPPORT



NOTE:
FINAL LOCATION FOR THE CONNECTION SHALL BE APPROVED BY THE CORRESPONDING COMPANY

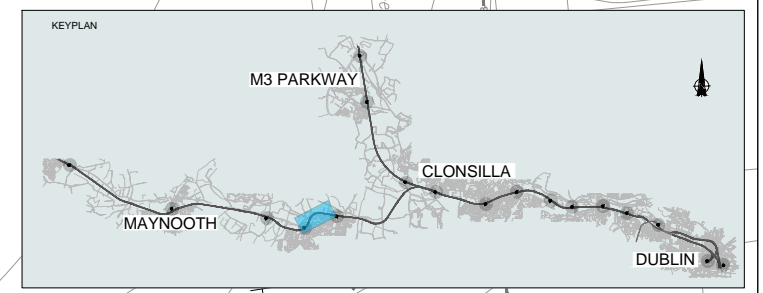

LEGEND FOR UTILITY SERVICES SURVEY AND PROPOSED DIVERSIONS:

— ESB — Existing ESB - Underground	— PROP. ESB MV — Proposed ESB - MV Underground Diversion	— PROP. VIRGIN — Proposed VIRGIN Diversion
— OH — Existing ESB - Overhead	— PROP. ESB HV — Proposed ESB - HV Overhead Diversion	— PROP. VODAFONE — Proposed VODAFONE Diversion
— EIRCOM — Existing EIRCOM	— PROP. ESB MV — Proposed ESB - MV Overhead Diversion	— PROP. AURORA — Proposed AURORA Diversion
— STORM WATER — Existing Storm Water	— PROP. ESB LV — Proposed ESB - LV Overhead Diversion	— PROP. EU — Proposed EU Network Diversion
— GAS — Existing Gas Network	— PROP. ESB HV — Proposed ESB - HV Underground Diversion	— PROP. GAS LP — Proposed GAS LP Diversion
— GRAVITY FOUL — Existing IW-Gravity	— PROP. IW-WM — Proposed IW- WATER Main Diversion	— PROP. GAS MP — Proposed GAS MP Diversion
— VIRGIN — Existing Virgin	— PROP. IW-GF — Proposed IW-GRAVITY FOUL Diversion	— PROP. GAS HP — Proposed GAS HP Diversion
— VODAFONE — Existing Vodafone	— PROP. SW — Proposed STORM WATER Diversion	— IRISH RAIL PROPERTY BOUNDARY — Irish Rail Property Boundary
— EU Network — Existing EU Network	— PROP. EIRCOM — Proposed EIRCOM Diversion	
— AURORA — Existing Aurora		
— WM — Existing Water Main		

V 01	May 2022	Planning Issue	JHC	LA	CCH
REV.	DATE	DESCRIPTION	PRODUCED BY	REVIEWED BY	APPROVED BY

© Irish Rail (2021). This drawing is confidential and the copyright in it is owned by Irish Rail. This drawing must not be either loaned, copied or otherwise reproduced in whole or in part or used for any purpose without the prior permission of Irish Rail.
 © Ordnance Survey, Ireland and Government of Ireland. All O.S. data used for plans are printed under "Copyright Ordnance Survey Ireland".
 Survey No. 0039720 (OSI Aerial Data or OS Lidar Data) & Survey No. 2021/081, NMA, 180 (OSI Vector Data).
 All elevations are in metres and relate to OS Geoid Model (OSGM02) Mean Head as defined by existing Project Control.
 All Co-ordinates are in Irish Transverse Mercator Grid (ITM) as defined by OSI active GPS station Tallaght College (TLTG).

Client: **Thionscáil Éireann Project Ireland 2040**, **NTA**, **Iarnród Éireann Irish Rail**

Consultant: **IDOM**, **G3**, **FIROD**

Project: **DART+ West**

Drawing Title: **UTILITIES DIVERSIONS OBG-14 BRIDGE DECK RECONSTRUCTION**

Scale: 1:200 @ A1

Drawing Number: **MAY MDC UTL RS12 DR Y 0001 D**

Date: May 2022 | Job No: P/101086 | Status: F1-Approved&Accepted | Rev: V 01 | Sheet: 01 of 01

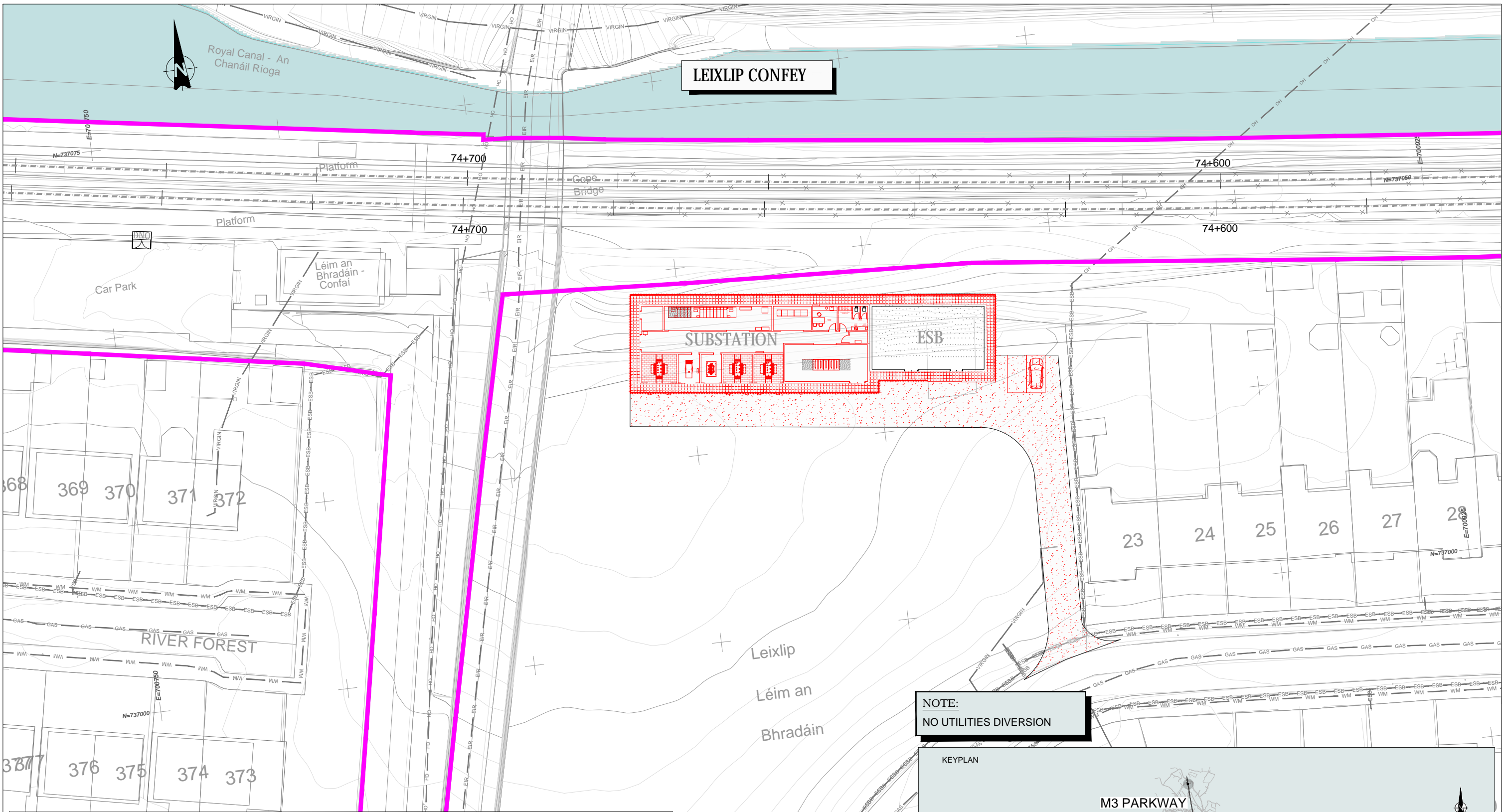

LEIXLIP CONFÉY

NOTE:
NO UTILITIES DIVERSION



LEGEND FOR UTILITY SERVICES SURVEY AND PROPOSED DIVERSIONS:

—ESB—ESB—ESB— Existing ESB - Underground	—PROP. ESB MV/LV— Proposed ESB - MV/LV Underground Diversion	—PROP. VIRGIN— Proposed VIRGIN Diversion
—OH— Existing ESB - Overhead	—PROP. ESB HV— Proposed ESB - HV Overhead Diversion	—PROP. VODAFONE— Proposed VODAFONE Diversion
—EIRCOM— Existing EIRCOM	—PROP. ESB MV— Proposed ESB - MV Overhead Diversion	—PROP. AUR— Proposed AURORA Diversion
—STORM WATER— Existing Storm Water	—PROP. ESB LV— Proposed ESB - LV Overhead Diversion	—PROP. EU— Proposed EU Network Diversion
—GAS— Existing Gas Network	—PROP. ESB HV— Proposed ESB - HV Underground Diversion	—PROP. GAS LP— Proposed GAS LP Diversion
—GRAVITY FOUL— Existing IW-Gravity	—PROP. IW-GM— Proposed IW- WATER Main Diversion	—PROP. GAS MP— Proposed GAS MP Diversion
—VIRGIN— Existing Virgin	—PROP. IW-GF— Proposed IW-GRAVITY FOUL Diversion	—PROP. GAS HP— Proposed GAS HP Diversion
—VODAFONE— Existing Vodafone	—PROP. SW— Proposed STORM WATER Diversion	—IRISH RAIL BOUNDARY— Irish Rail Property Boundary
—EU Network— Existing EU Network	—PROP. EIRCOM— Proposed EIRCOM Diversion	
—AURORA— Existing Aurora		
—WM— Existing Water Main		

Client	Tionscadal Éireann Project Ireland 2040			NTA Udarás Náisiúnta Ionstrá Náisiúnta Transport Authority			Iarnród Éireann Irish Rail		
Consultant	IDOM			G3			IROD		
Project	DART+ West								
Drawing Title	UTILITIES DIVERSION LEIXLIP CONFÉY SUBSTATION								
Scale:	1:250 @ A1								
Drawing Number	Project	Originator	Discipline	Location	Type	Role	Number	Phase	
MAY	MDC	UTL	RS12	DR	Y	0002	D		
Date:	May 2022	Job No:	P/101086	Status:	F1-Approved&Accepted	Rev:	V 01	Sheet:	01 of 01

© Irish Rail (2021). This drawing is confidential and the copyright in it is owned by Irish Rail. This drawing must not be either loaned, copied or otherwise reproduced in whole or in part or used for any purpose without the prior permission of Irish Rail.
 © Ordnance Survey, Ireland and Government of Ireland. All O.S. data used for plans are printed under "Copyright Ordnance Survey Ireland".
 Survey No. 0039720 (OSI Aerial Data or OS Lidar Data) & Survey No. 2021/081, NMA, 180 (OSI Vector Data).
 All elevations are in metres and relate to OS Geoid Model (OSGM02) Mean Head as defined by existing Project Control.
 All Co-ordinates are in Irish Transverse Mercator Grid (ITM) as defined by OS active GPS station Tallaght College (TLTG).

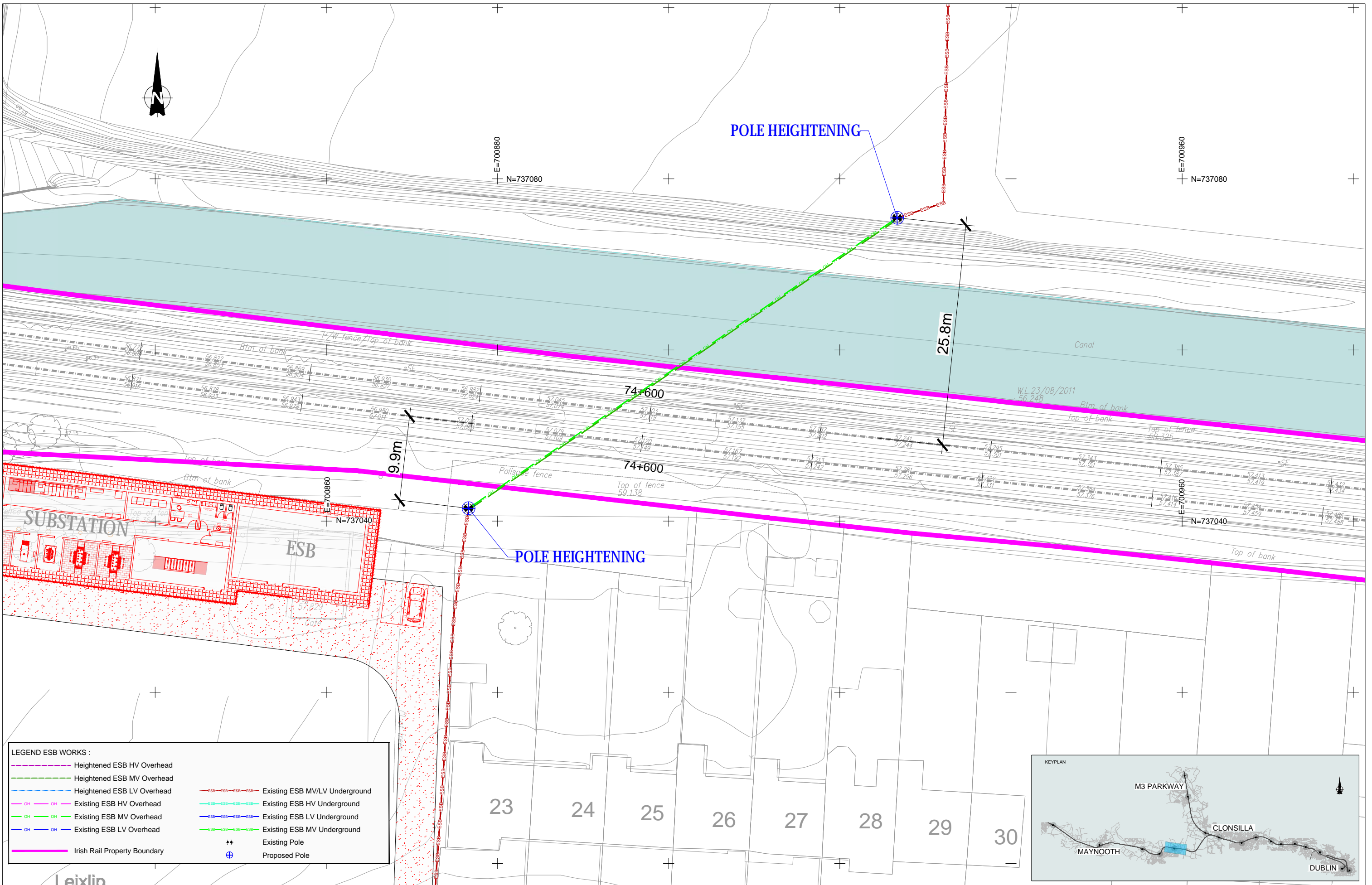

LEGEND ESB WORKS :

	Heightened ESB HV Overhead		Existing ESB MV/LV Underground
	Heightened ESB MV Overhead		Existing ESB HV Underground
	Heightened ESB LV Overhead		Existing ESB LV Underground
	Existing ESB HV Overhead		Existing ESB MV Underground
	Existing ESB MV Overhead		Existing ESB LV Underground
	Existing ESB LV Overhead		Existing ESB MV Underground
	Irish Rail Property Boundary		Existing Pole
			Proposed Pole

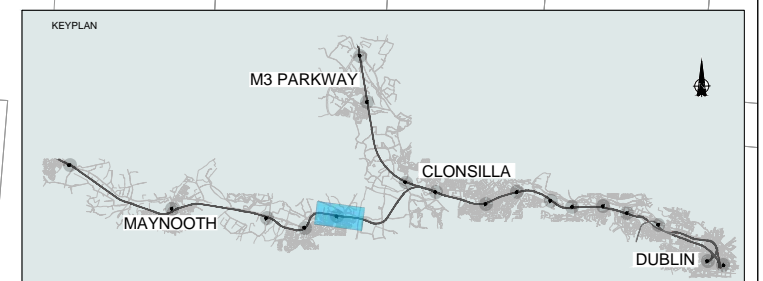

Client	Tionscald Eireann Project Ireland 2040		
Consultant	IDOM		
Project	DART+ West		
Drawing Title	UTILITIES DIVERSIONS LEIXLIP CONVEY STATION MEDIUM & LOW VOLTAGE LAYOUT PLAN		
Scale:	1:200 @ A1		
Drawing Number	Project	Originator	Discipline
May 2022	P/101086	F1-Approved&Accepted	V 01
Date:	Job No:	Status:	Rev:
May 2022	P/101086	F1-Approved&Accepted	V 01
REV.	DATE	DESCRIPTION	PRODUCED BY
V 01	May 2022	Planning Issue	JHC
			LA
			CCH

© Irish Rail (2021). This drawing is confidential and the copyright in it is owned by Irish Rail. This drawing must not be either loaned, copied or otherwise reproduced in whole or in part or used for any purpose without the prior permission of Irish Rail.

© Ordnance Survey, Ireland and Government of Ireland. All O.S. data used for plans are printed under "Copyright Ordnance Survey Ireland".

Survey No. 0039720 (OSi Aerial Data or OSi Lidar Data) & Survey No. 2021081, NMA, 180 (OSi Vector Data).

All elevations are in metres and relate to OSi Geoid Model (OSGM02) Mean Head as defined by existing Project Control.

All Co-ordinates are in Irish Transverse Mercator Grid (ITM) as defined by OSi active GPS station Tallaght College (TLG0).

Scale: 1:200 @ A1

0 1.25 2.5 5 10

Drawing Number | Project | Originator | Discipline | Location | Type | Role | Number | Phase

MAY MDC UTL RS12 DR Y 0220 D

Date: May 2022 | Job No: P/101086 | Status: F1-Approved&Accepted | Rev: V 01 | Sheet: 01 of 01

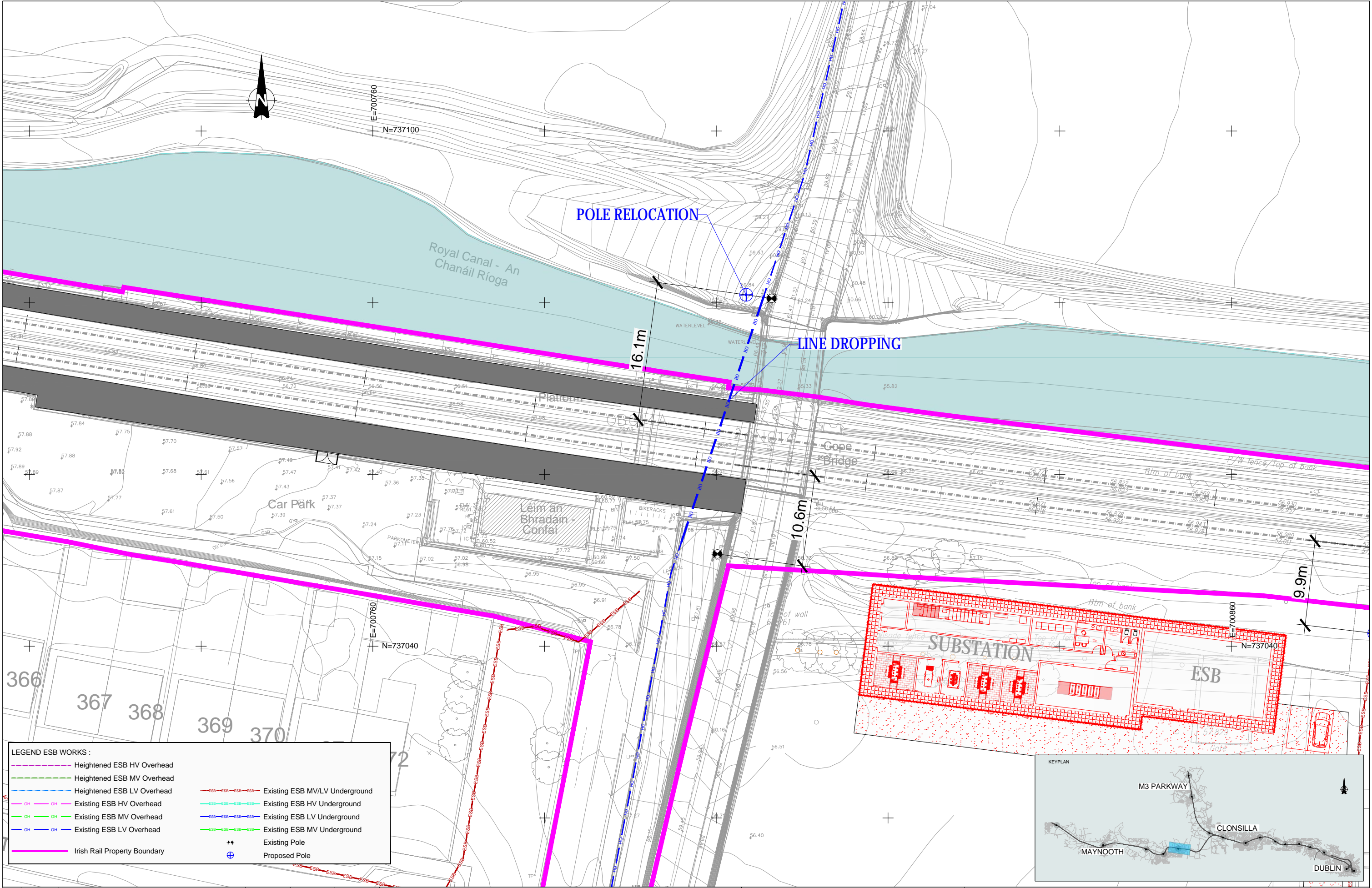

LEGEND ESB WORKS :

	Heightened ESB HV Overhead		Existing ESB MV/LV Underground
	Heightened ESB MV Overhead		Existing ESB HV Underground
	Heightened ESB LV Overhead		Existing ESB LV Underground
	Existing ESB HV Overhead		Existing ESB MV Underground
	Existing ESB MV Overhead		Existing ESB LV Underground
	Existing ESB LV Overhead		Existing ESB MV Underground
	Irish Rail Property Boundary		Existing Pole
			Proposed Pole

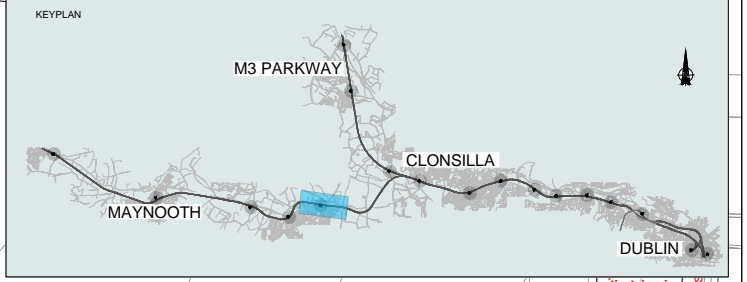

V 01	May 2022	Planning Issue	JHC	LA	CCH
REV.	DATE	DESCRIPTION	PRODUCED BY	REVIEWED BY	APPROVED BY

© Irish Rail (2021). This drawing is confidential and the copyright in it is owned by Irish Rail. This drawing must not be either loaned, copied or otherwise reproduced in whole or in part or used for any purpose without the prior permission of Irish Rail.
 © Ordnance Survey, Ireland and Government of Ireland. All O.S. data used for plans are printed under "Copyright Ordnance Survey Ireland".
 Survey No. 0039720 (OSI Aerial Data or OS Lidar Data) & Survey No. 2021/081, NMA, 180 (OSI Vector Data).
 All elevations are in metres and relate to OS Geoid Model (OSGM02) Mean Head as defined by existing Project Control.
 All Co-ordinates are in Irish Transverse Mercator Grid (ITM) as defined by OS active GPS station Tallaght College (TLG0).

Client

Consultant

Project

Drawing Title

UTILITIES DIVERSIONS
LEIXLIP CONFEEY STATION - OBG14
MEDIUM & LOW VOLTAGE LAYOUT PLAN

Scale: 1:200 @ A1

Drawing Number | Project | Originator | Discipline | Location | Type | Role | Number | Phase
MAY MDC UTL RS12 DR Y 0230 D

Date: May 2022 | Job No: P/101086 | Status: F1-Approved&Accepted | Rev: V 01 | Sheet: 01 of 01

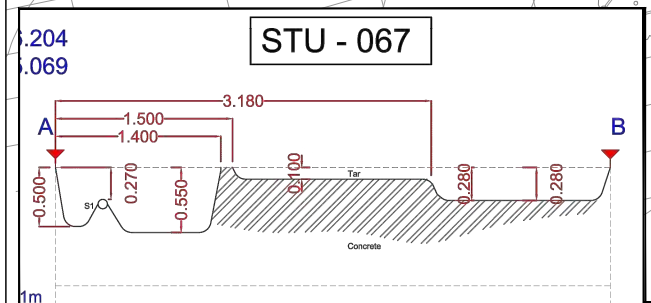
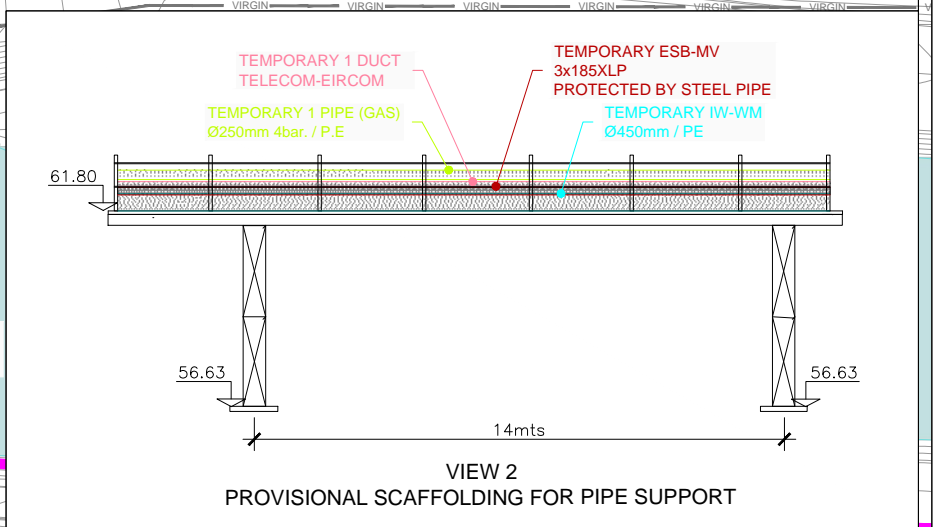
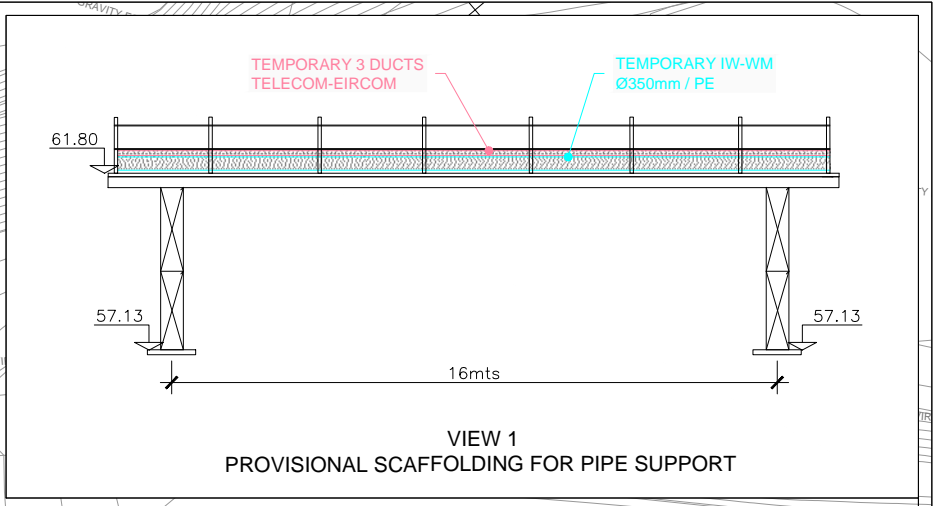
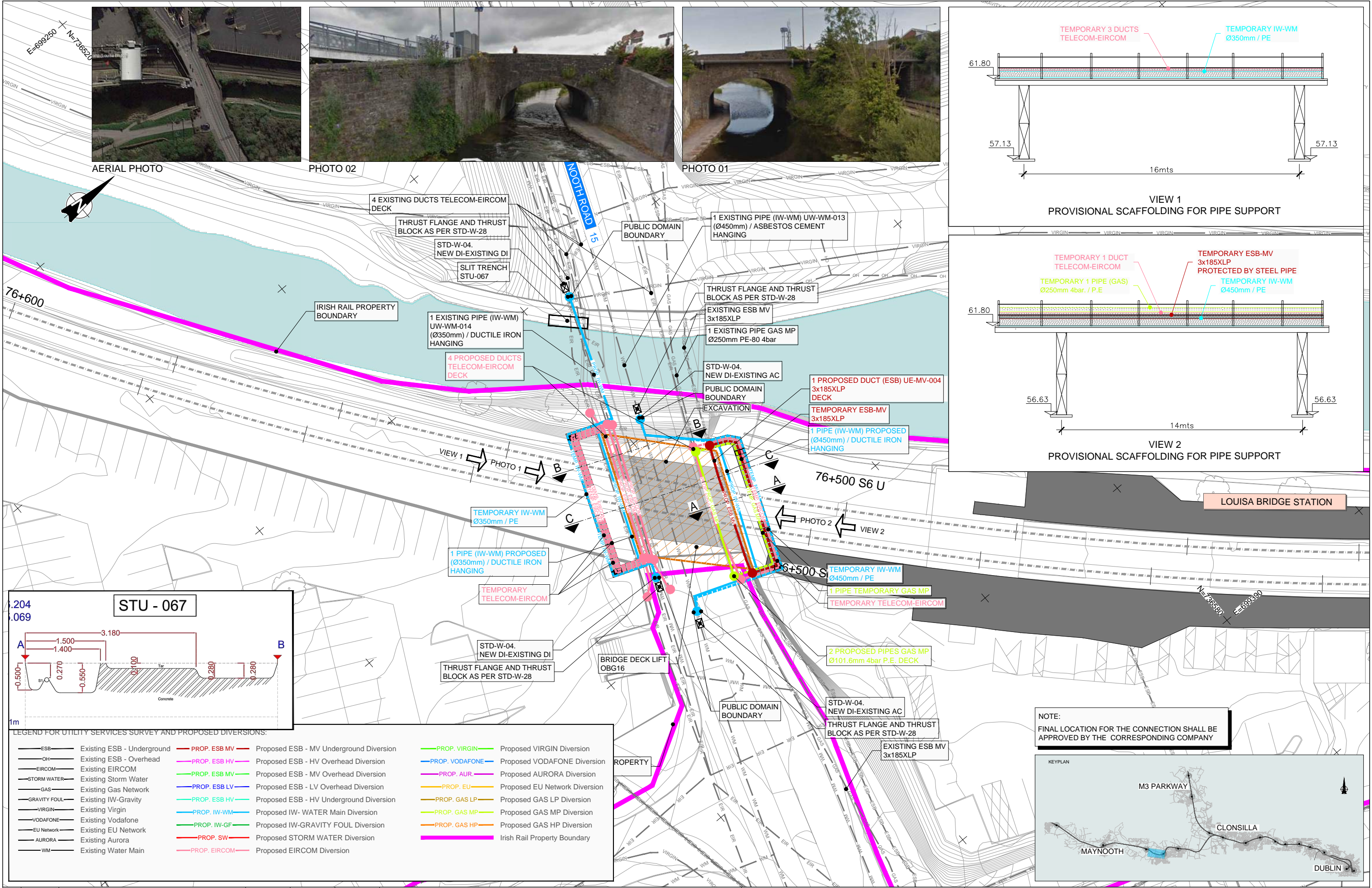

LEGEND FOR UTILITY SERVICES SURVEY AND PROPOSED DIVERSIONS:

— ESB —	Existing ESB - Underground	— PROP. ESB MV —	Proposed ESB - MV Underground Diversion	— PROP. VIRGIN —	Proposed VIRGIN Diversion
— OH —	Existing ESB - Overhead	— PROP. ESB HV —	Proposed ESB - HV Overhead Diversion	— PROP. VODAFONE —	Proposed VODAFONE Diversion
— EIRCOM —	Existing EIRCOM	— PROP. ESB MV —	Proposed ESB - MV Overhead Diversion	— PROP. AUR —	Proposed AURORA Diversion
— STORM WATER —	Existing Storm Water	— PROP. ESB LV —	Proposed ESB - LV Overhead Diversion	— PROP. EU —	Proposed EU Network Diversion
— GAS —	Existing Gas Network	— PROP. ESB HV —	Proposed ESB - HV Underground Diversion	— PROP. GAS LP —	Proposed GAS LP Diversion
— GRAVITY FOUL —	Existing IW-Gravity	— PROP. IW-WM —	Proposed IW- WATER Main Diversion	— PROP. GAS MP —	Proposed GAS MP Diversion
— VIRGIN —	Existing Virgin	— PROP. IW-GF —	Proposed IW-GRAVITY FOUL Diversion	— PROP. GAS HP —	Proposed GAS HP Diversion
— VODAFONE —	Existing Vodafone	— PROP. SW —	Proposed STORM WATER Diversion	—	—
— EU Network —	Existing EU Network	— PROP. EIRCOM —	Proposed EIRCOM Diversion	—	—
— AURORA —	Existing Aurora				
— WM —	Existing Water Main				

NOTE:
FINAL LOCATION FOR THE CONNECTION SHALL BE APPROVED BY THE CORRESPONDING COMPANY

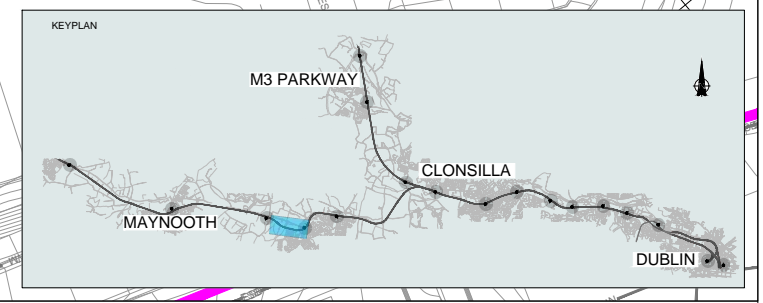

Client: Thionscatal Éireann Project Ireland 2040 Consultant: IDOM			Project: Irish Rail Drawing Title: UTILITIES DIVERSIONS OBG-16 BRIDGE DECK RECONSTRUCTION		
V 01 May 2022 Planning Issue REV. DATE DESCRIPTION JHC LA CCH PRODUCED BY REVIEWED BY APPROVED BY	Scale: 1:200 @ A1 0 1.25 2.5 5 10		Drawing Number Project Originator Discipline Location Type Role Number Phase MAY MDC UTL RS13 DR Y 0001 D Date: May 2022 Job No: P/101086 Status: F1-Approved&Accepted Rev: V 01 Sheet: 01 of 02		

SECTION A-A

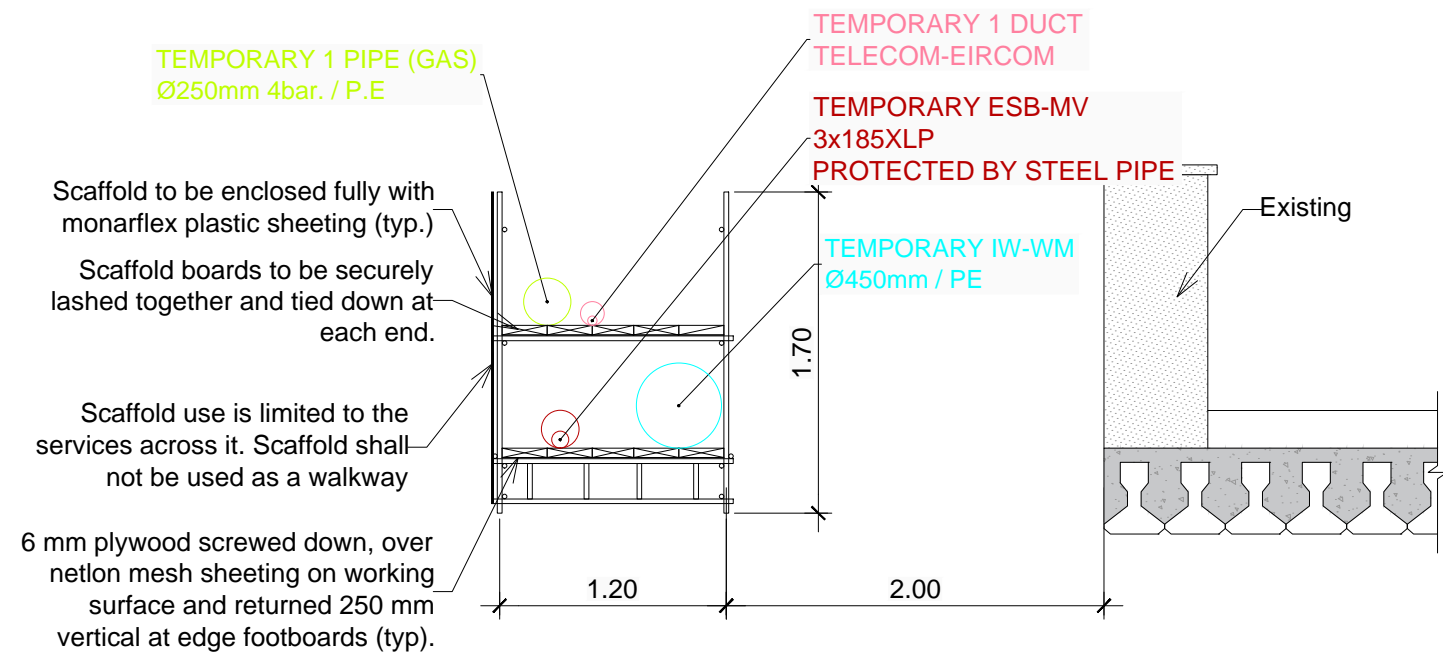

SECTION B-B

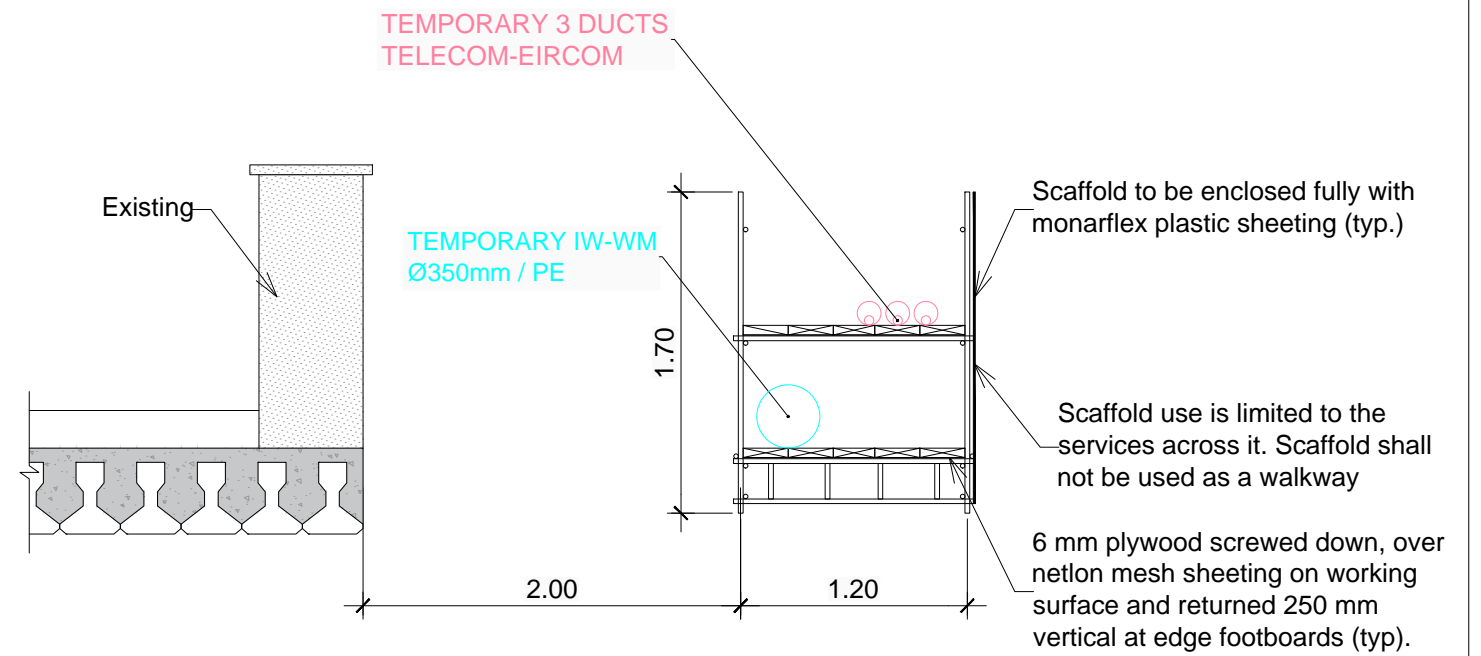

SECTION C-C

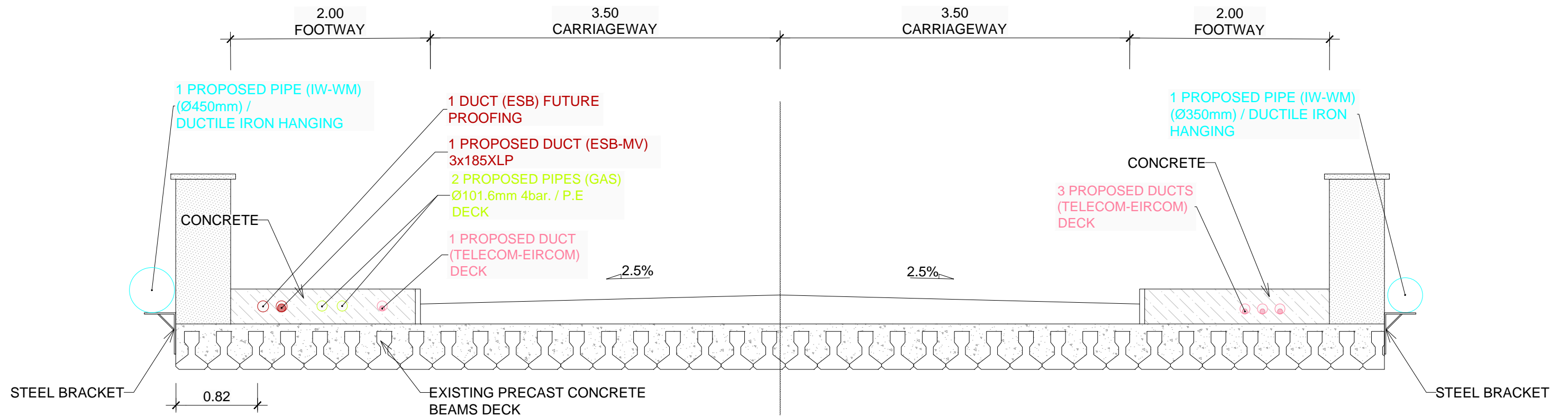

REV.	DATE	DESCRIPTION	JHC	LA	CCH
V 01	May 2022	Planning Issue			
© Irish Rail (2021). This drawing is confidential and the copyright in it is owned by Irish Rail. This drawing must not be either loaned, copied or otherwise reproduced in whole or in part or used for any purpose without the prior permission of Irish Rail.			PRODUCED BY REVIEWED BY APPROVED BY		
© Ordnance Survey, Ireland and Government of Ireland. All O.S. data used for plans are printed under "Copyright Ordnance Survey Ireland"			Survey No. 0039720 (OSI Aerial Data or OSI Lidar Data) & Survey No. 2021/OSI_NMA_180 (OSI Vector Data).		
All elevations are in metres and relate to OS Geoid Model (OSGM02) Mean Head as defined by existing Project Control.			All Co-ordinates are in Irish Transverse Mercator Grid (ITM) as defined by OSI active GPS station Tallaght College (TLG0).		

Client

Thionscaldal Éireann Project Ireland 2040

NTA Údarás Náisiúnta Comair

Iarnród Éireann Irish Rail

Consultant

IDOM

G3

FIROD

Project

DART+ West

Drawing Title

UTILITIES DIVERSIONS
OBG-16
CROSS SECTIONS

Scale: 1:200 @ A1

Drawing Number | Project | Originator | Discipline | Location | Type | Role | Number | Phase
MAY MDC UTL RS13 DR Y 0001 D

Date: May 2022 Job No: P/101086 Status: F1-Approved&Accepted Rev: V 01 Sheet: 02 of 02

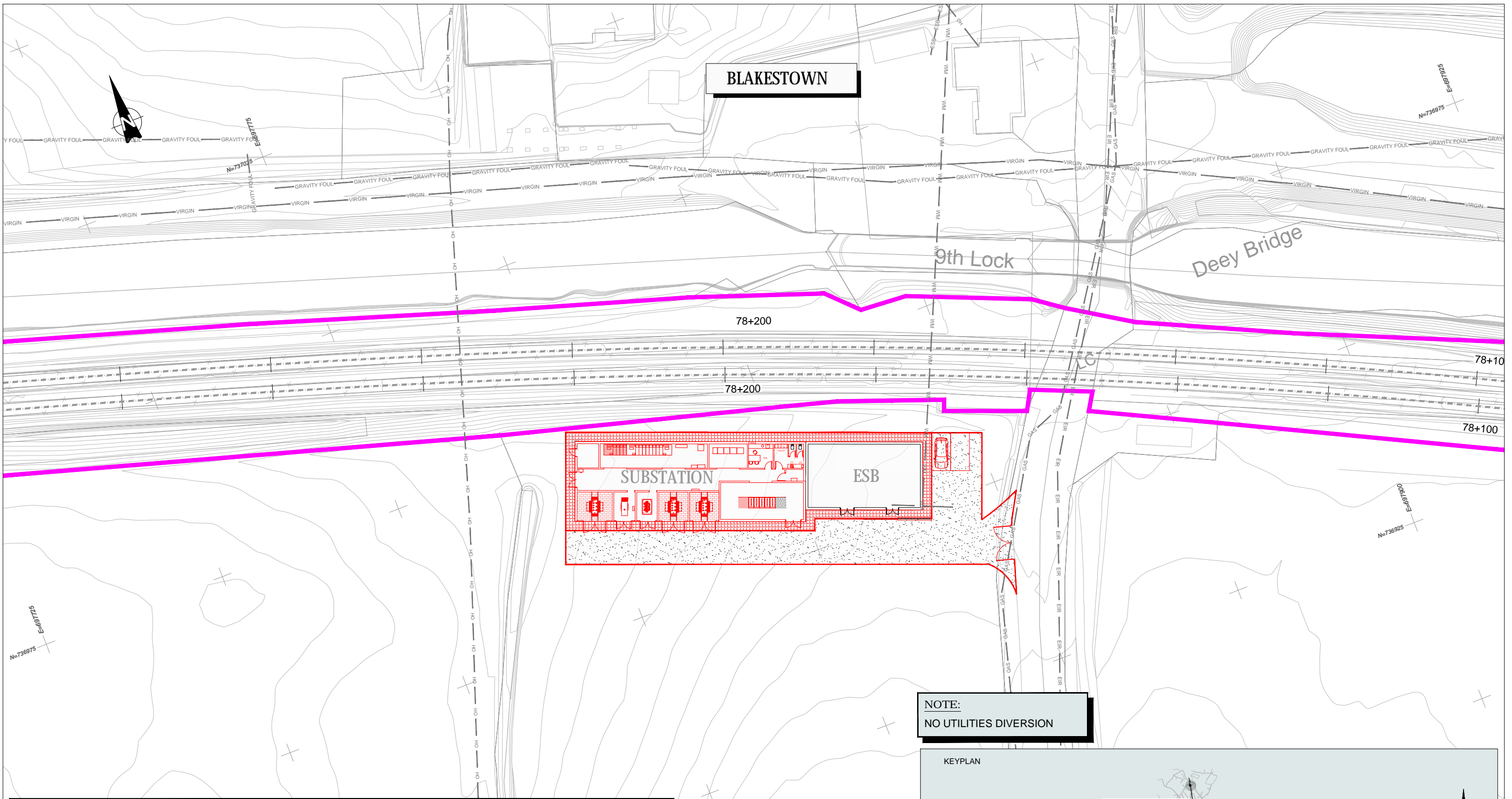

BLAKESTOWN

NOTE:
NO UTILITIES DIVERSION

LEGEND FOR UTILITY SERVICES SURVEY AND PROPOSED DIVERSIONS:

— ESB —	Existing ESB - Underground	— PROP. ESB MV —	Proposed ESB - MV Underground Diversion	— PROP. VIRGIN —	Proposed VIRGIN Diversion
— OH —	Existing ESB - Overhead	— PROP. ESB HV —	Proposed ESB - HV Overhead Diversion	— PROP. VODAFONE —	Proposed VODAFONE Diversion
— EIRCOM —	Existing EIRCOM	— PROP. ESB MV —	Proposed ESB - MV Overhead Diversion	— PROP. AUR —	Proposed AURORA Diversion
— STORM WATER —	Existing Storm Water	— PROP. ESB LV —	Proposed ESB - LV Overhead Diversion	— PROP. EU —	Proposed EU Network Diversion
— GAS —	Existing Gas Network	— PROP. ESB HV —	Proposed ESB - HV Underground Diversion	— PROP. GAS LP —	Proposed GAS LP Diversion
— GRAVITY FOUL —	Existing IW-Gravity	— PROP. IW-WM —	Proposed IW- WATER Main Diversion	— PROP. GAS MP —	Proposed GAS MP Diversion
— VIRGIN —	Existing Virgin	— PROP. IW-GF —	Proposed IW-GRAVITY FOUL Diversion	— PROP. GAS HP —	Proposed GAS HP Diversion
— VODAFONE —	Existing Vodafone	— PROP. SW —	Proposed STORM WATER Diversion	—	—
— EU Network —	Existing EU Network	— PROP. EIRCOM —	Proposed EIRCOM Diversion	—	—
— AURORA —	Existing Aurora				
— WM —	Existing Water Main				

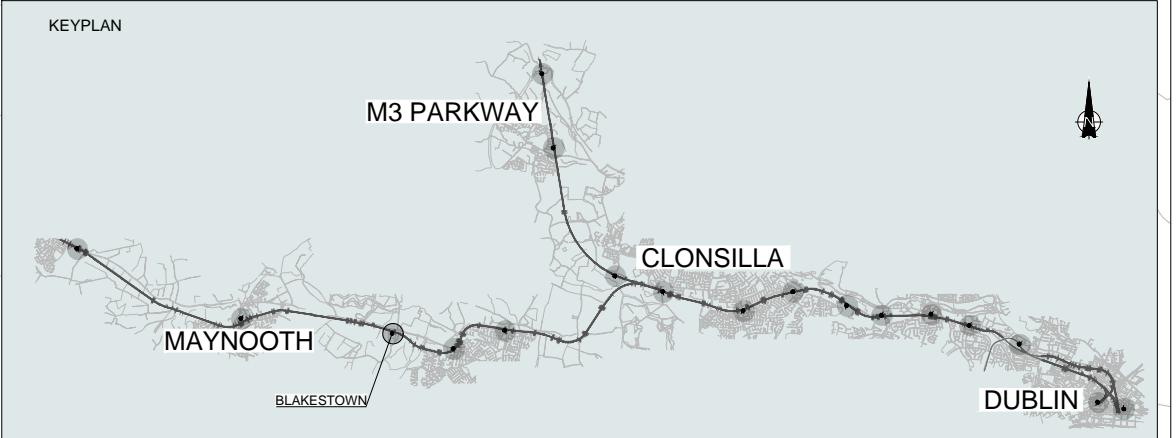

Client	Tionscail Éireann Project Ireland 2040	NTA Udarás Náisiúnta Iompartha National Transport Authority	Iarnród Éireann Irish Rail
Consultant	IDOM	G3	FIROD R. O'DONOVAN
Project	DART+ West		
Drawing Title	UTILITIES DIVERSION BLAKESTOWN SUBSTATION		
Scale:	1:250 @ A1		
Drawing Number	Project	Originator	Discipline
MAY	MDC	UTL	LC06
Date:	Job No:	Status:	Rev:
May 2022	P/101086	F1-Approved&Accepted	V 01
REV.	DATE	DESCRIPTION	APPROVED BY
V 01	May 2022	Planning Issue	JHC LA CCH
			PRODUCED BY REVIEWED BY APPROVED BY

© Irish Rail (2021). This drawing is confidential and the copyright in it is owned by Irish Rail. This drawing must not be either loaned, copied or otherwise reproduced in whole or in part or used for any purpose without the prior permission of Irish Rail.
 © Ordnance Survey, Ireland and Government of Ireland. All O.S. data used for plans are printed under "Copyright Ordnance Survey Ireland".
 Survey No. 0039720 (OS Aerial Data or OS Lidar Data) & Survey No. 2021/051, NMA, 180 (OS Vector Data).
 All elevations are in metres and relate to OS Geoid Model (OSGM02) Mean Head as defined by existing Project Control.
 All Co-ordinates are in Irish Transverse Mercator Grid (ITM) as defined by OS active GPS station Tallaght College (TLG0).

Scale:	1:250 @ A1		
Drawing Number	Project	Originator	Discipline
MAY	MDC	UTL	LC06
Date:	Job No:	Status:	Rev:
May 2022	P/101086	F1-Approved&Accepted	V 01
REV.	DATE	DESCRIPTION	APPROVED BY
V 01	May 2022	Planning Issue	JHC LA CCH